

Active Pull-Out Faucet - ACT-PO-PWT | 115.0656.851

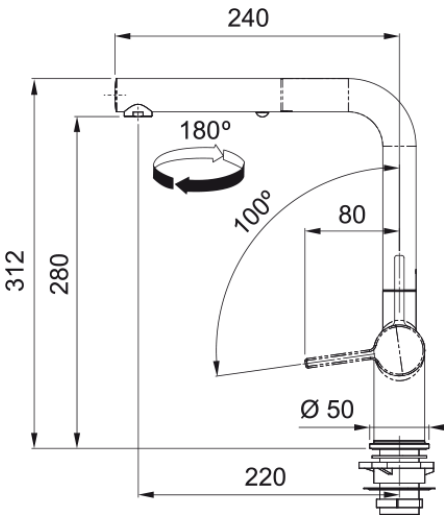

Technical Data

| Aspect | |
|--------------------------------|-----------------------|
| Spout type | L - spout |
| Color | Bi-chrome/polar white |
| Type of material | Brass |
| Flexible pullout hose material | Nylon grey |
| Spray head material | Brass |
| Product Dimensions | |
| Faucet hole diameter | 35 mm |
| Cartridge dimension | 35 mm |
| Installation | |
| Mounting type | Shank |
| Water supply hose connection | 1/2" |
| Water supply hose length | 450 mm |
| Product specifications | |
| Pressure | High pressure |
| Faucet type | Spray |
| Faucet operation | Side lever |
| Faucet rotation | 180° |
| Product identification | |
| Product brand | FRANKE |
| Product family | Maris |
| Collection | Active |
| Features | |
| Water saving feature | Yes |
| Type of aerator | Laminar |