

TA9701 Atlas Neo SS Pull-Out Tap | 115.0616.119

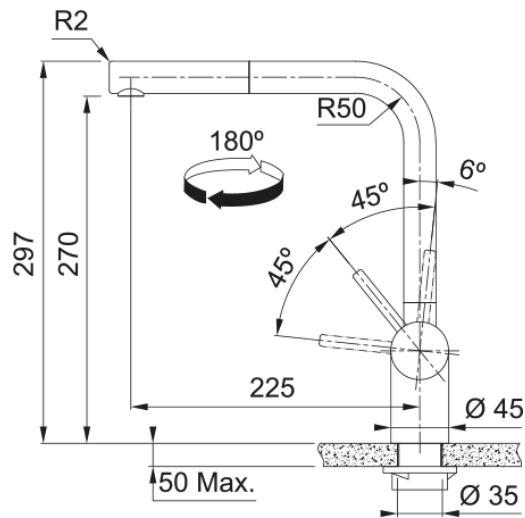

TA9701 Atlas Neo Stainless Steel Pull-Out Tap.

<b>Aspect</b>	
Spout type	L - spout
Colour	Stainless steel
Material type	Stainless steel 304
Pull-out hose material	Textile
Pull-out head material	Stainless steel
<b>Dimensions</b>	
Tap hole diameter	35 mm
Cartridge	35 mm
<b>Installation</b>	
Fixation type	Shank
Water hose connection	3/8"
Water supply hose length	600 mm
<b>Product features</b>	
Pressure	High pressure
Spout type	Pull out
Tap operation	Side lever
Tap rotation	180°
<b>Product identification</b>	
Brand	FRANKE
Product family	Maris
Family	ATLAS NEO
<b>Properties</b>	
Eco water saving	No
Type of aerator	Laminar