

Atlas Neo SS Non Pull-Out Tap TA9700 | 115.0616.118

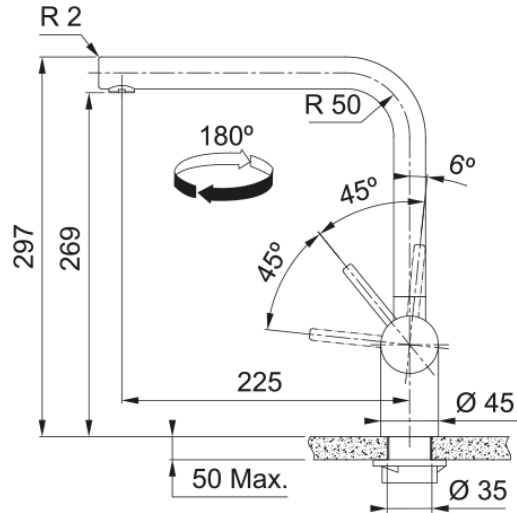

Technical Data

Aspect	
Spout type	L - spout
Colour	Stainelss steel
Material type	Stainless steel 304
Dimensions	
Tap hole diameter	35 mm
Cartridge	35 mm
Installation	
Fixation type	Shank
Water hose connection	3/8"
Water supply hose length	600 mm
Product features	
Pressure	High pressure
Spout type	Swivel
Tap operation	Side lever
Tap rotation	180°
Product identification	
Brand	FRANKE
Product family	Maris
Family	Atlas Neo
Properties	
Eco water saving	No
Type of aerator	Laminar

