

Maris Lario Hot/Cold Filtered LAR-HC-SNI | 120.0740.032

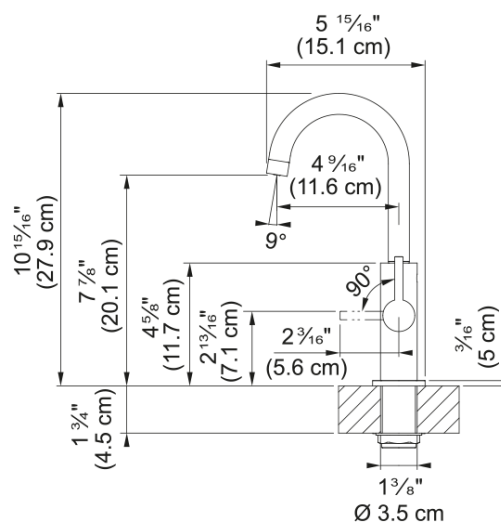

Maris Lario 10.3-in Dual-Handle Hot and Cold Water Filtration Faucet in Satin Nickel. Experience the convenience of instant filtered hot and cold water with the Maris Lario Hot and Cold Filtered Beverage Faucet. Designed and made in Italy, it combines timeless style with advanced functionality for everyday use. A built-in safety lock ensures controlled access to hot water, while the cold-body system keeps the faucet cool-to-the-touch, even when dispensing hot water. Available in Chrome, Satin Nickel, and Matte Black, this sleek, space-saving faucet pairs perfectly with other faucets in the Maris Lario collection, creating a cohesive and elegant look throughout your kitchen.

Aspect

Spout type	J - spout
Product color	Satin Nickel
Type of material	Brass

Product Dimensions

Height Overall	10.236
Faucet hole diameter	35 mm
Cartridge dimension	1/2" headworks

Installation

Mounting type	Shank
Water supply hose connection	3/8"
Water supply hose length	60.00 in

Product specifications

Pressure	High pressure
Faucet type	Swivel
Faucet operation	Dual Lever
Faucet rotation	360°

Product identification

Brand	FRANKE
Product family	Maris
Collection	Maris Lario

Features

Water saving feature	No
Type of aerator	Honeycomb
Application	Chilled Water
Application	Hot Water

Application

Water filtration