

# VITAL

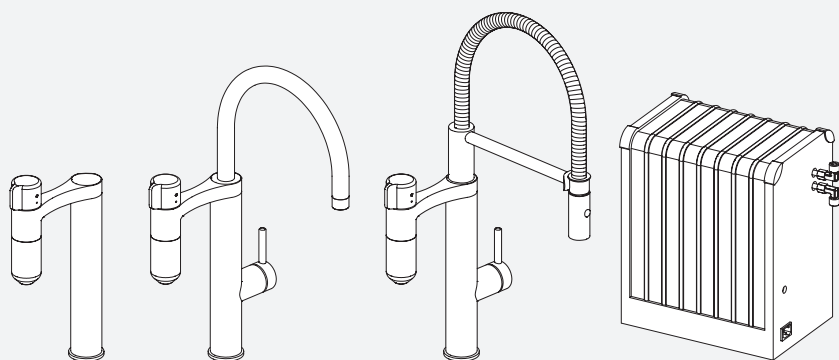

EN	Installation and user manual
DE	Installations- und Gebrauchsanweisung
FR	Manuel d'installation et mode d'emploi
NL	Installatie- en gebruikershandleiding
IT	Manuale per l'installazione e l'uso
ES	Manual de instalación y servicio
PT	Manual de instalação e de assistência
EL	Εγκατάσταση και εγχειρίδιο συντήρησης
DA	Installations- og servicevejledning
NO	Installasjons- og servicemanual
SV	Installations- och servicehandbok
FI	Asennus- ja käyttöohje
LT	Montavimas ir vartotojo vadovas
LV	Uzstādīšana un lietotāja rokasgrāmata
ET	Päigaldus ja kasutusjuhend

Kitchen Faucet
Küchenmischer
Robinet de cuisine
Keukenkraan
Rubinetto cucina
Grifo de cocina
Misturadora de cozinha
Μπαταρία κουζίνας
Køkkenblandingsbatteri
Kjøkkenkran
Köksblandare
Keittiöhana
Virtuvinis maišytuvas
Virtuves jaučējkrāns
Köögikraan

**FRANKE**

**A**

Vital Capsule Solo

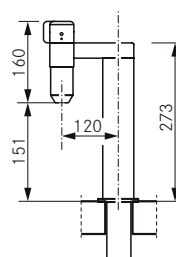
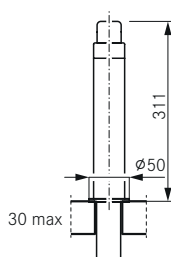
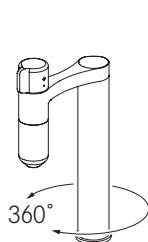
**B**

Vital Capsule Tap swivel J-spout

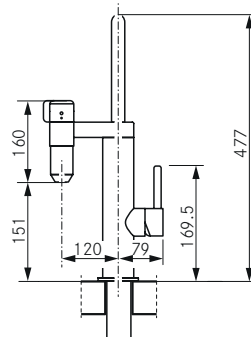
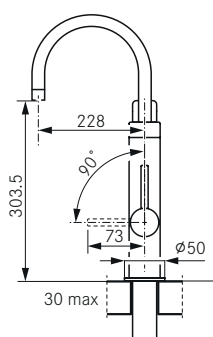
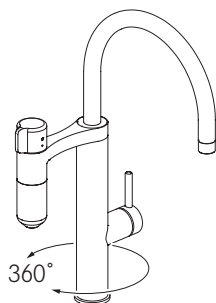
**C**

Vital Capsule Tap swivel Highflex-spout

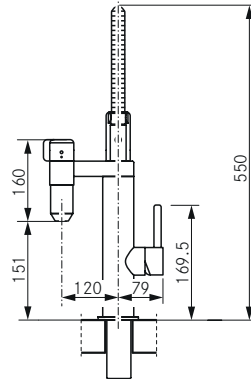
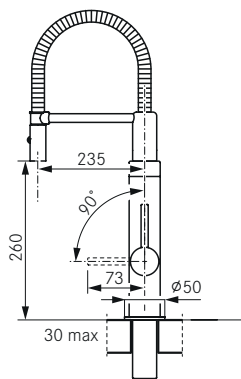
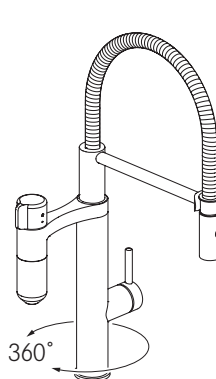

**D** FRANKE Chiller CT 2,5L, 220V-50Hz

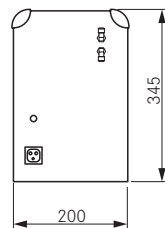
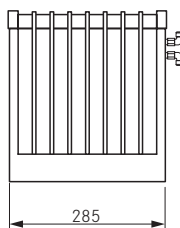
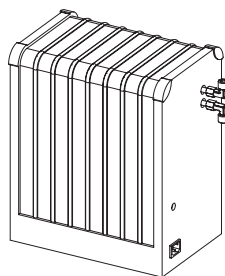

**i B C**

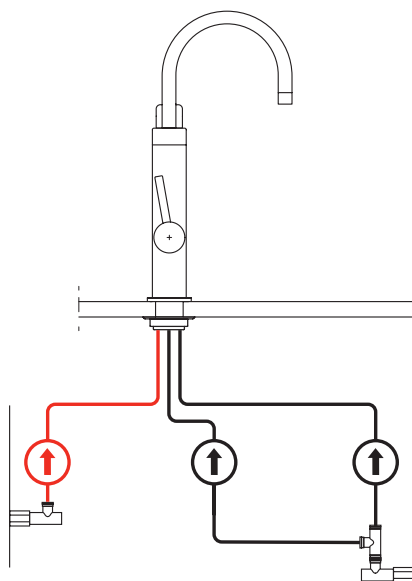

**i B C D**

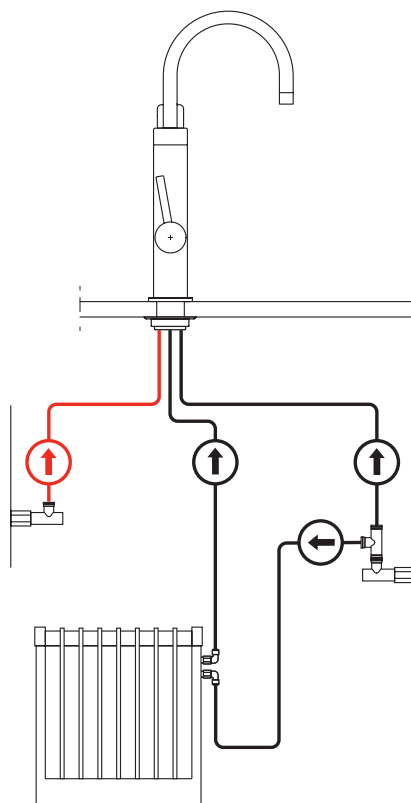

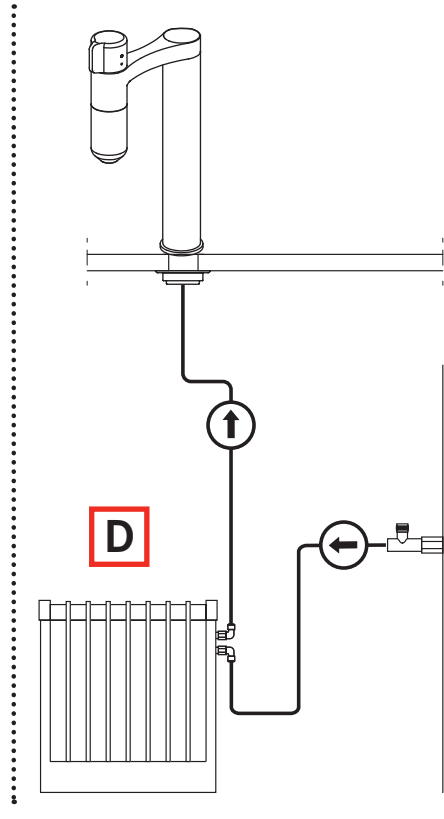
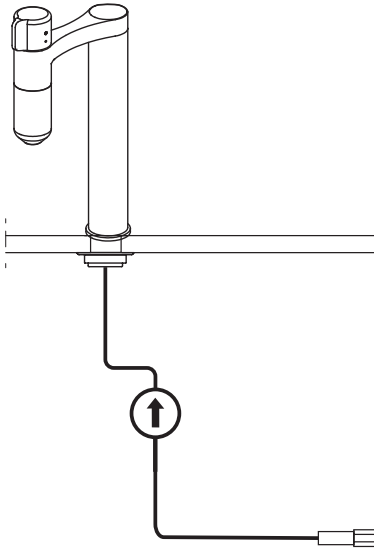



**A**

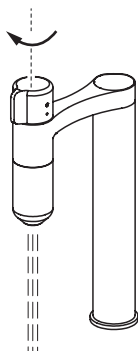

**B**

**1**

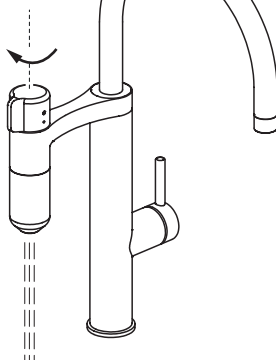

**2**

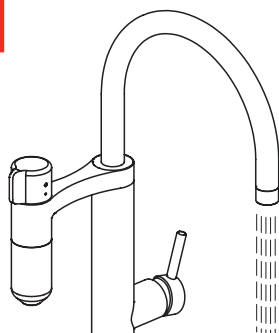

**C**

**1**

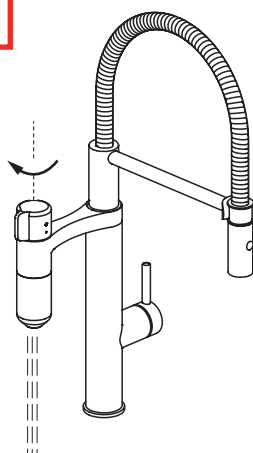

2

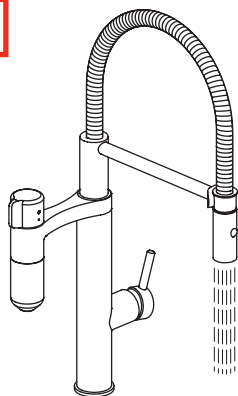

3

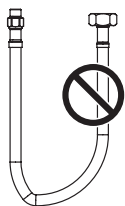

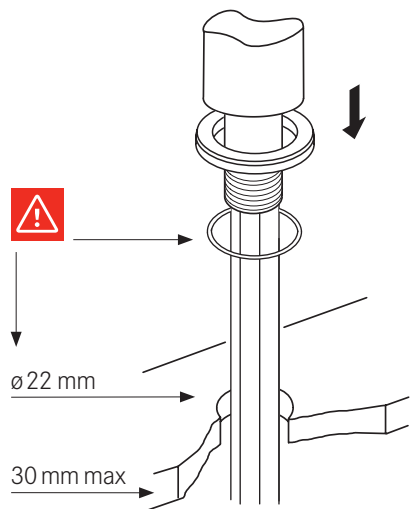
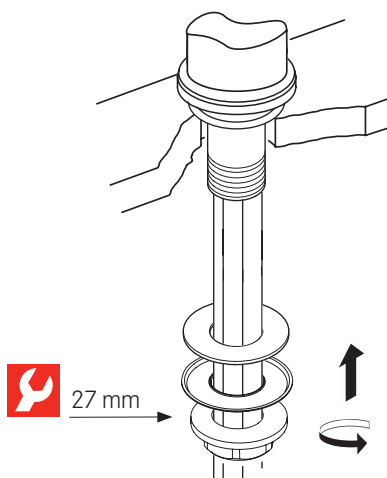
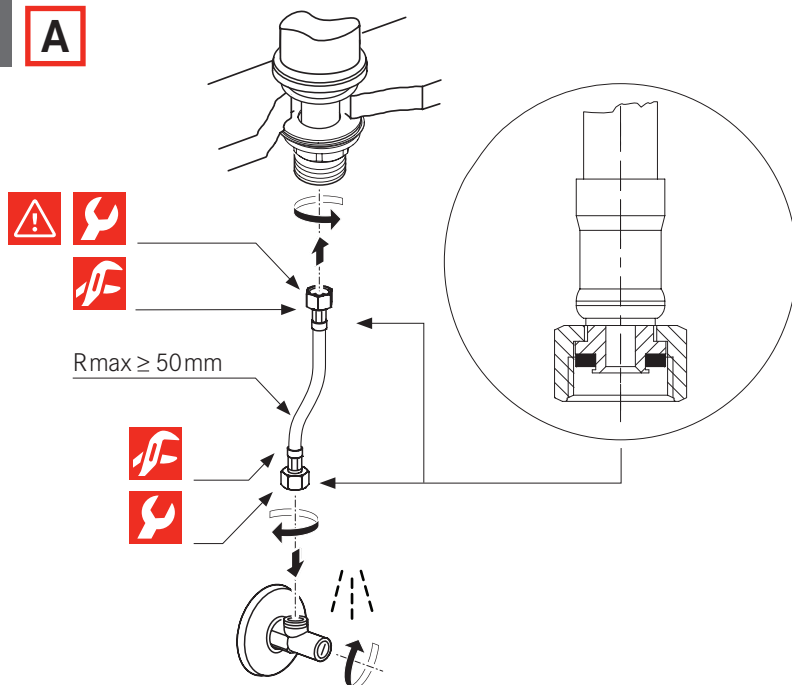
**1****A****2****A****3****A**

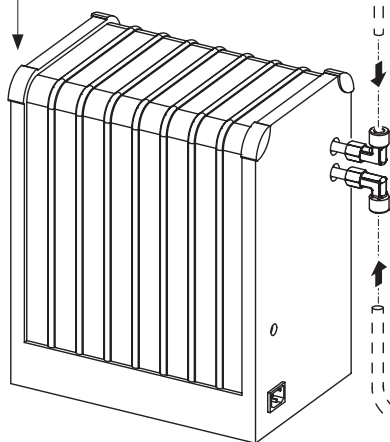
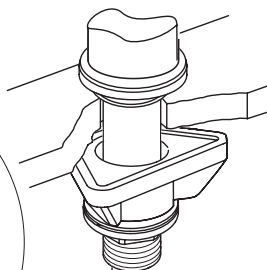
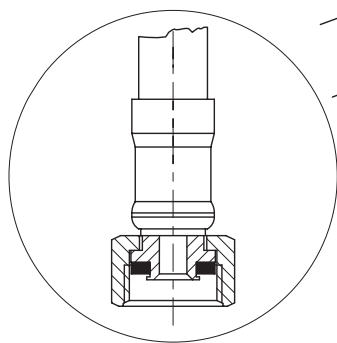

$R_{max} > 50\text{ mm} / 2''$

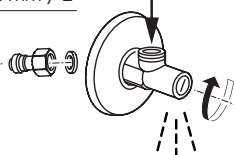



1

B

C

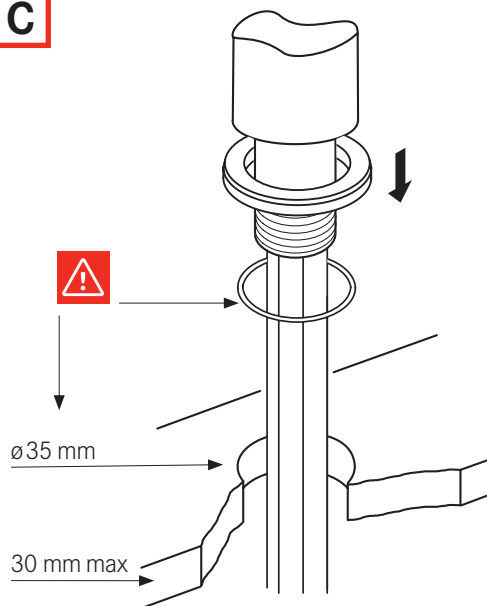

2

B

C

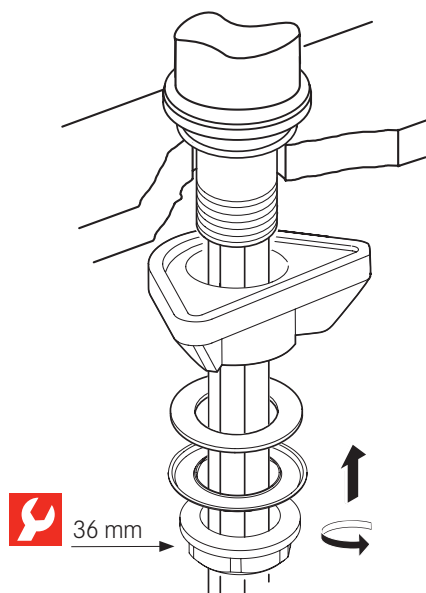

3

B

C

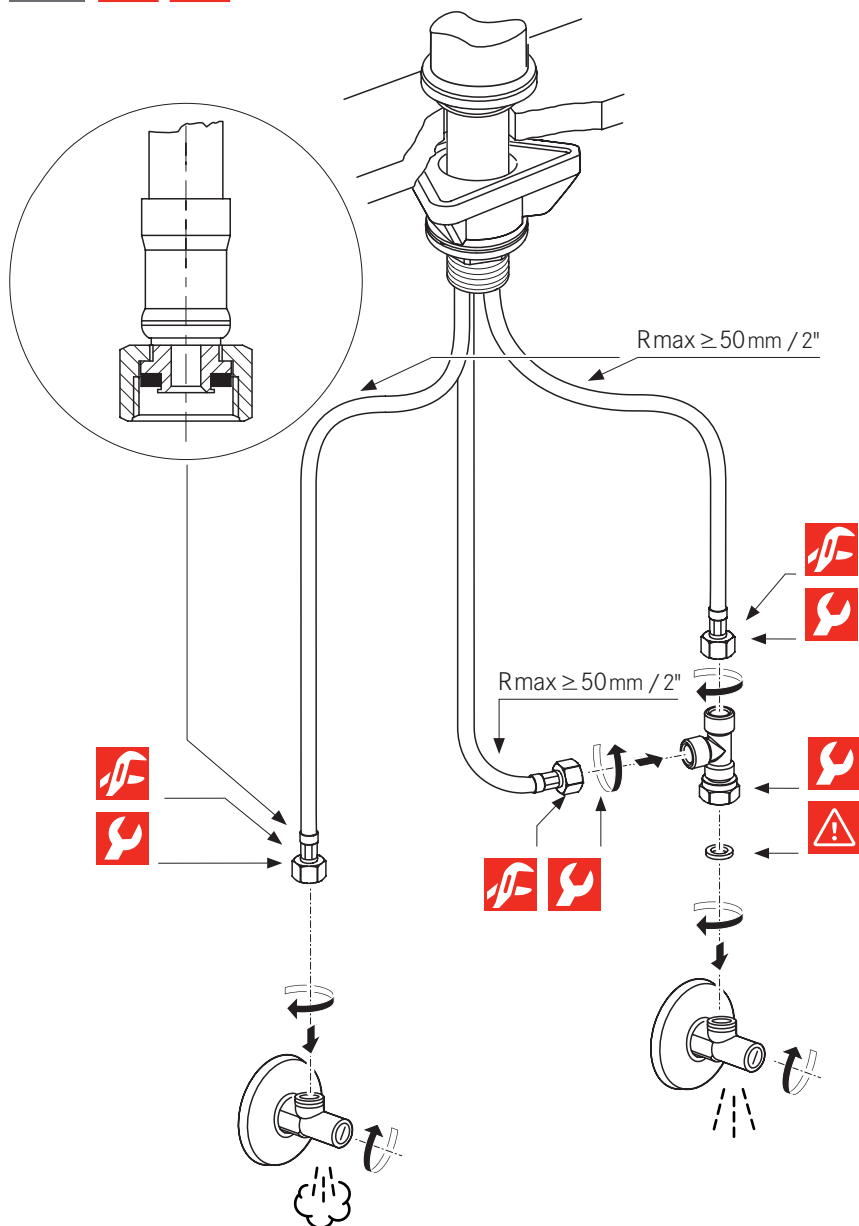

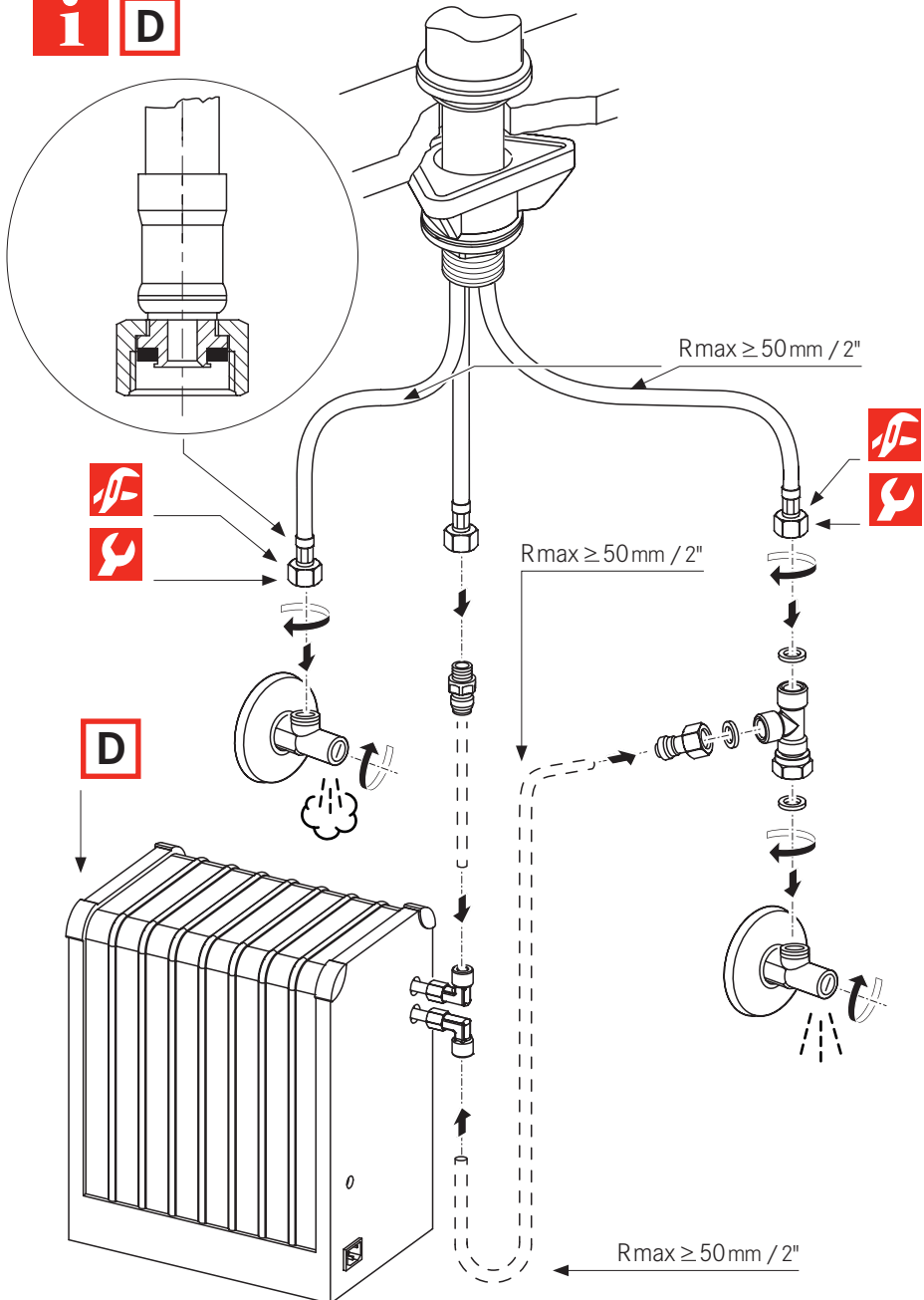

4

**B**

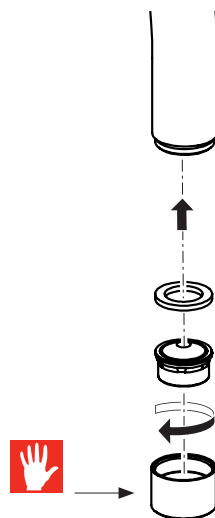
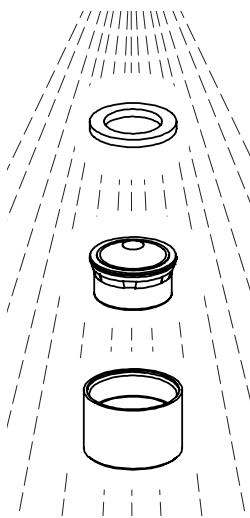
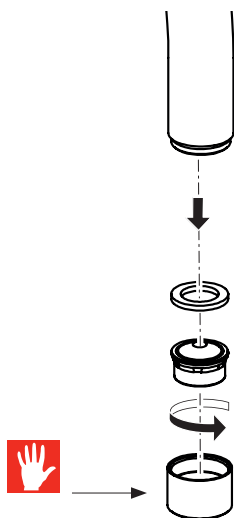

4

**C**

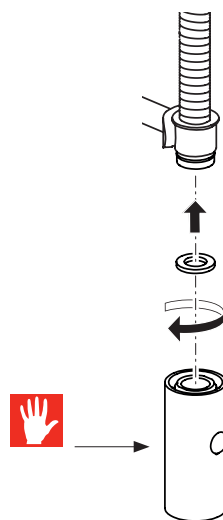
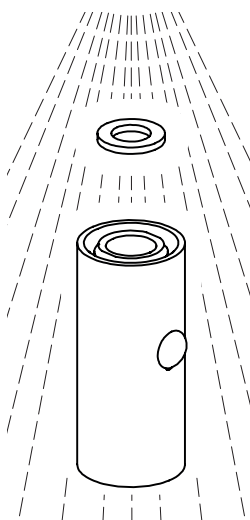
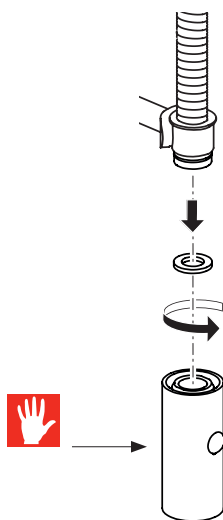



1

A

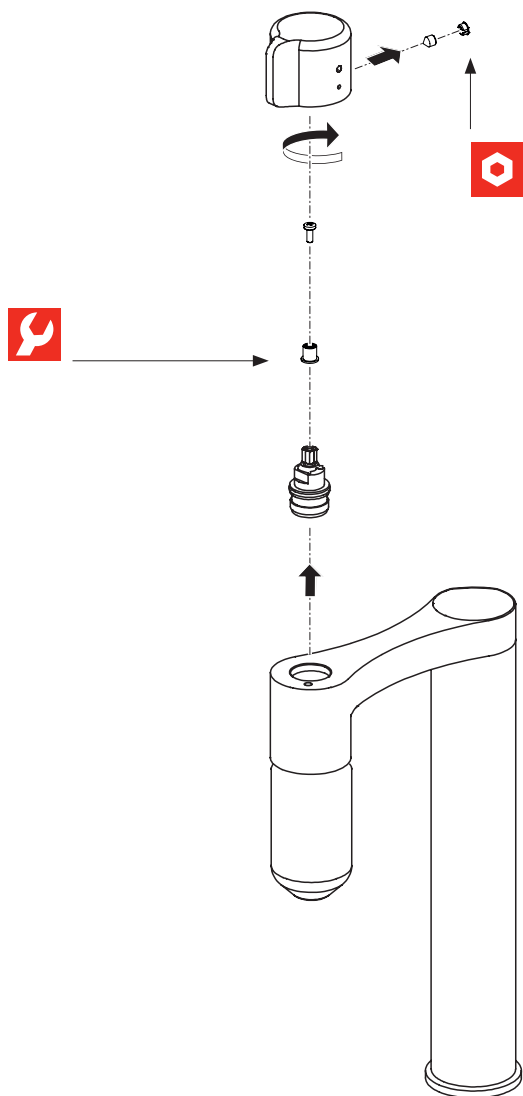

**B**

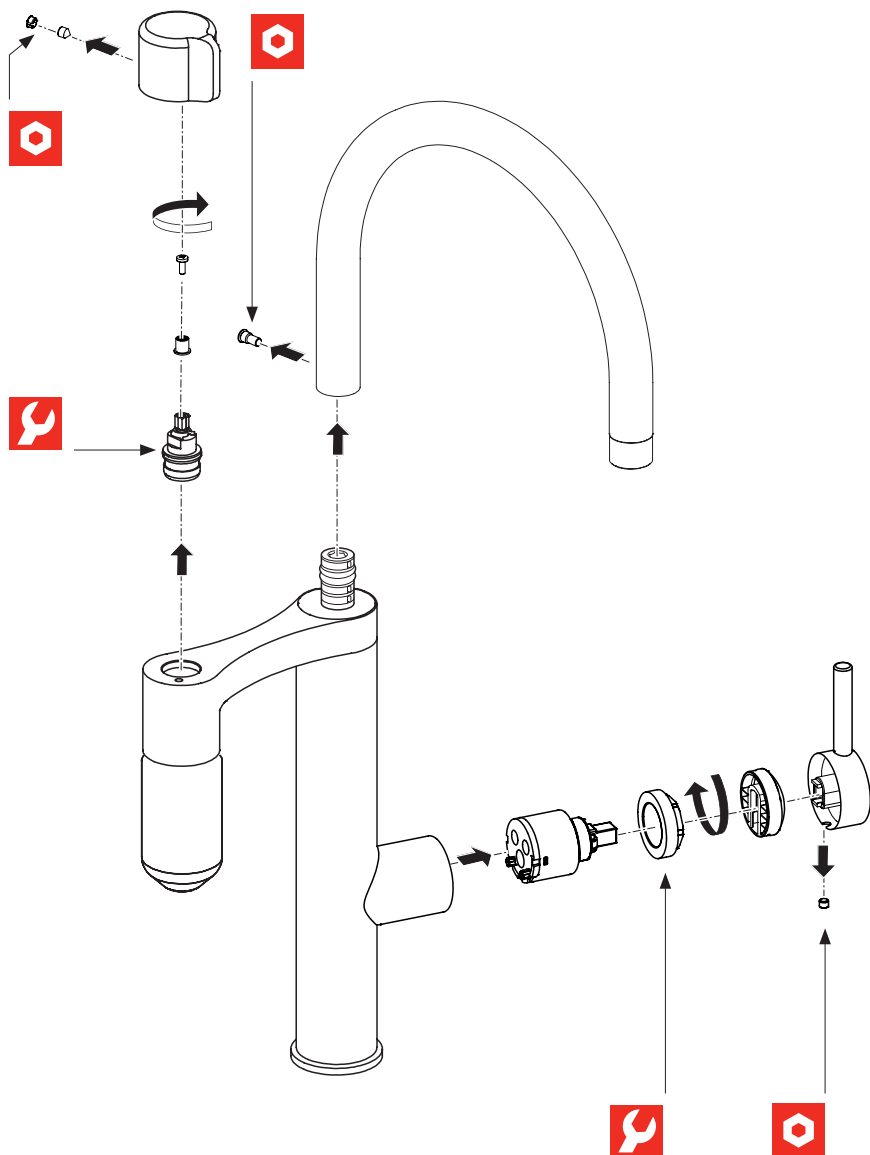

C

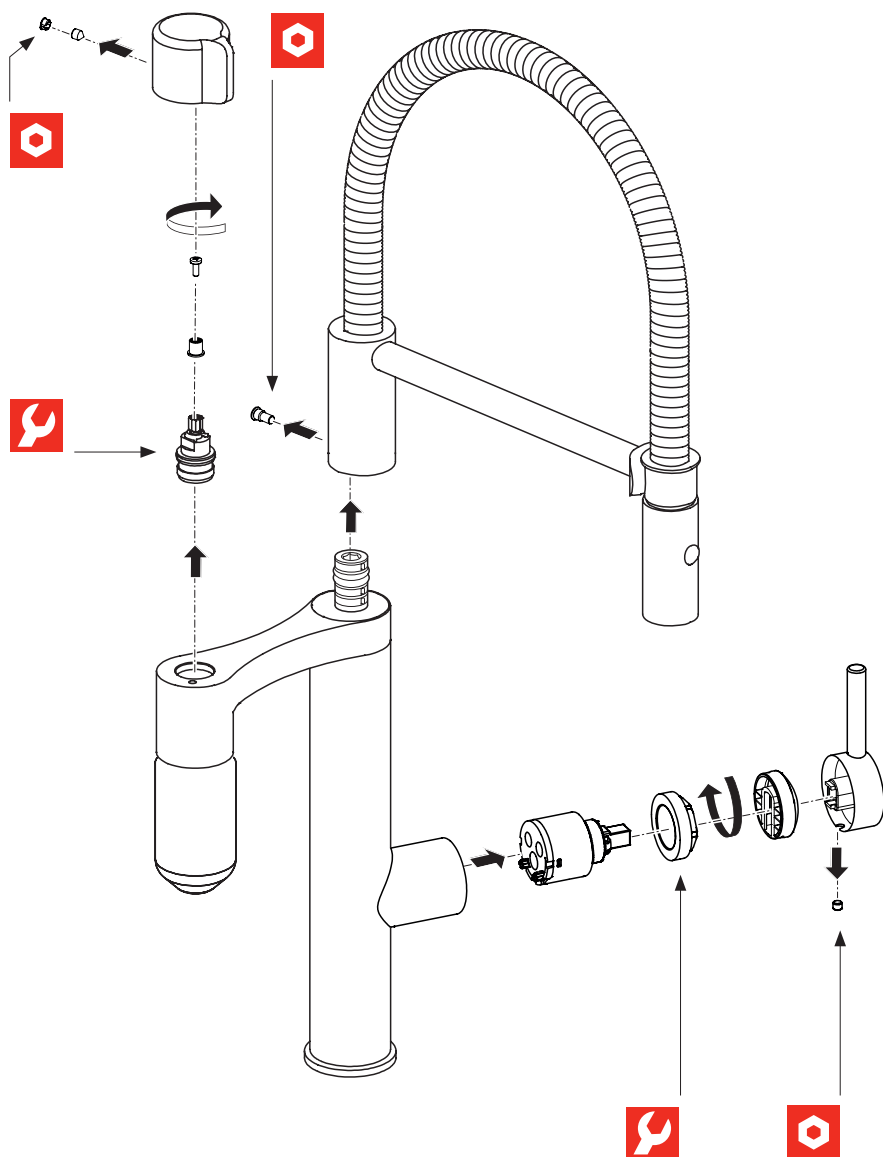

2

A

B

C

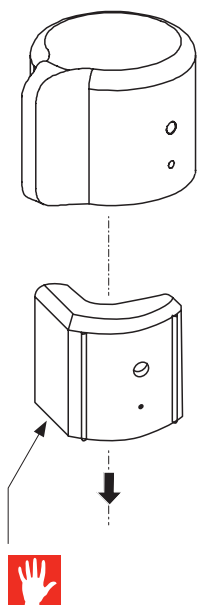

3

A

B

C

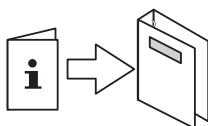
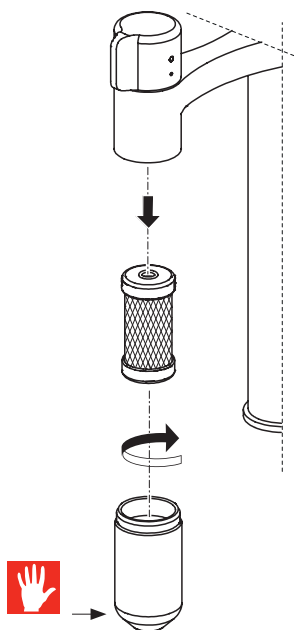

[www.franke.com](http://www.franke.com)



# PRODUCT INFORMATION

## Capsule filter

The Franke Filter Capsule is the first system of its kind to combine active carbon filtration with state-of-the-art membrane purification.

The water is filtered point-of-use to guarantee highest product safety and hygiene.

Operating data for Capsule Filter	Value	
Flow rate	@ 3 bar	3.5 L/ min
Pressure	2 bar	
Capacity	500 L	
Temperature range	5 °C	65 °C

## Filter cartridge

Water is filtered thanks to the patented filter technology. Bacteria, viruses, microplastics and microparticles, odors, pesticides and hormones are removed from the tap water during filtration process.

During periods with high water collection it is better to set the thermostat at maximum. In this way the cooling circuit is able to provide an ice reserve that would be necessary during the times of high operation of the machine.

## Chiller

Chiller is an optional device that can be additionally connected with the Vital capsule filter system and used to chill water.

To modify the temperature just turn the control handle (or the regulation screw) following the label placed near the thermostat.

Higher values mean colder water.

It is possible to enable and disable cold water dispensing as well as temperature control by acting on the thermostat. During periods with low water collection it is better to set the thermostat at minimum.

# INSTALLATION

## General starting points for installation

- ▷ Perform the following steps before starting installation.
- ▷ Stop valves must already be installed.
- ▷ Close the stop valves.
- ▷ In existing installations, remove the tap, hoses and boiler if still in place.
- ▷ Mark the existing cold and hot water connection.
- ▷ If Chiller is to be used as part of the system, there must be wall plug socket available for connection.

**IMPORTANT:** For subsequent steps, it will be required to cut and route tubing to fit the specific application in your home. All tubing must be cut squarely and free of burrs. Ensure there is no damage within 1" of the cut end.

- ▷ DO NOT USE ANY FORM OF SEALING COMPOUNDS, this is not required for push fit connections, and using sealing compounds could cause leaks.
- ▷ All tubing connections must be firmly seated.
- ▷ Tubing must be routed to avoid sharp bends and have enough slack to avoid straining connections. A P-clip and mounting screw is included to hold the tubing in place as needed
- ▷ Pull gently on each connection to make sure they are secure. See images below for details on tubing installation and removal.

## How to insert/remove tubing in push fit connections

- ▶ Insert the tubing squarely (Fig. 1).
- ▶ Make sure to insert tubing completely (Fig. 2).
- ▶ To remove, push in collet and pull out tubing (Fig. 3).

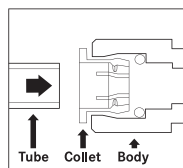

Fig.1

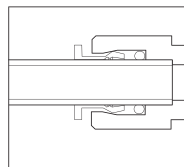

Fig.2

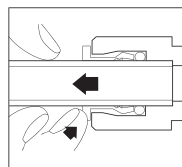

Fig.3

# SWITCHING ON FOR THE FIRST TIME

---

## Capsule filter

Before using Vital Capsule for the first time:

- ✓ Check if installation was done according to the manual.
- ✓ Check that water supply to the system is turned ON.
- ✓ Check if filter cartridge is in place
- ▶ Activate the electronic timer by pressing reset button for 3 seconds.
- ▶ Led light will blink: green, green, green indicating that system is ready. Then light will turn off.
- ▶ Filtration is ready

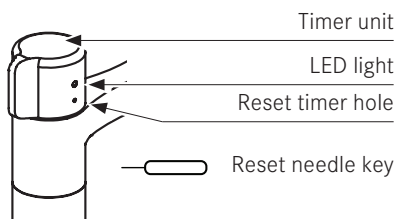

## Chiller

When you first use the product, in order to remove any air inside the system, it is recommended to:

- ▷ Open the water valve and wait a few minutes to make sure there are no water leakage.
- ▷ If the system includes electrical controls, connect the product to the power supply to enable the delivery keys.
- ▷ Press the cold water button to let the air out. Release the button only when the water starts coming out.
- ▷ Drain a few litres of cold and warm water.
- ▷ When you first install the product, you will have to wait approx. 1h before dispensing cold water.

# OPERATION

## Capsule Filter status indication

Filter status indication is timer based.  
LED light shows if filter is working or if battery and/ or filter cartridge need to be replaced.

Status indication	LED light appearance	User Action
Filter working	ON/ OFF green light	-
After 450 L	Light turns red when ON/OFF	Prepare/ purchase new filter cartridge
After 500 L	LED blinks red when ON/OFF	Replace filter cartridge
New battery needed.	LED light will blink green and red ON/ OFF until timer unit is replaced	Replace timer unit
During resetting timer During first installation	LED light will blink green, green, green	-

# MAINTENANCE

## Replacing timer unit

- ▷ See page 16/2 ABC.
- ▶ Repeat steps from paragraph FIRST INSTALLATION to reset LED.

- ▶ To replace filter cartridge refer to illustration on page 16/3.
- ▶ To reset timer for 3 seconds push button inside reset timer hole. LED light will blink 3 times. After LED light turns OFF, system is ready.

## Replacing filter cartridge and resetting timer

Filter must be replaced after 500 L of water. After replacing filter cartridge, reset timer.

## Periodic checks

- ▶ Check connection and shower hoses periodically for the following:

– Watertightness

– Corrosion

– Mechanical damage

▶ Use original spare parts only.
- ▶ Replace damp or dripping hoses. Replace hoses with rusty or oxidized surfaces.

▶ Replace hoses that show signs of mechanical damage.

▶ Flush all pipes thoroughly before installation.

Operating data	Value		
Operating pressure (ideal)	3 bar	45 PSI	300 kPa
Operating pressure (max.)*	5 bar	70 PSI	500 kPa
Operating pressure (min.)*	1 bar	14.5 PSI	100 kPa
Water temperature (ideal)	60 °C	140 °F	
Water temperature (max.)	80 °C	180 °F	

\* Equal pressure is recommended.

## DISPOSAL

### Chiller



The symbol on the product or on the packaging indicates that the device must not be disposed of in the domestic waste.

By disposing of the device in a proper way you help to avoid harmful consequences to environment and health.

Further information about recycling the device is available from the competent authority, the local refuse disposal service or the vendor of the device. Dispose of the device, which is to be discarded, via a specialised waste collection point for electronic and electrical devices.

In accordance with the article of Legislative Decree no. 15 dated 25 July, Implementation of Directive 2002/96/EC regarding the reduction of the hazardous substances used in electrical and electronic appliances, and waste disposal.

The barred dustbin symbol on the appliance indicates that at the end of its working life the product must not be disposed of as household waste.

Consequently, when the appliance has reached the end of its working life the user must take it to a suitable recycling centre for electronic and electrotechnical waste, or return it to the dealer when purchasing a new appliance of equivalent type.

Proper separate waste collection of the scrapped appliance for subsequent recycling, treatment and environmentally-friendly disposal helps prevent a potentially negative impact on the environment and health and facilitates recycling of the materials used in appliance construction.

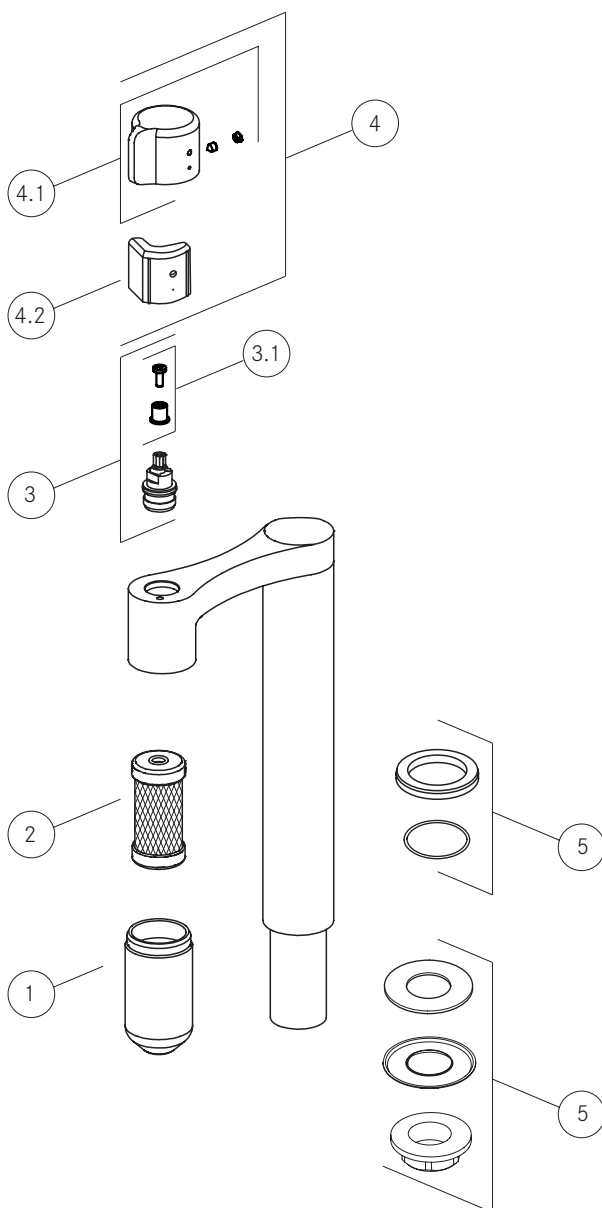

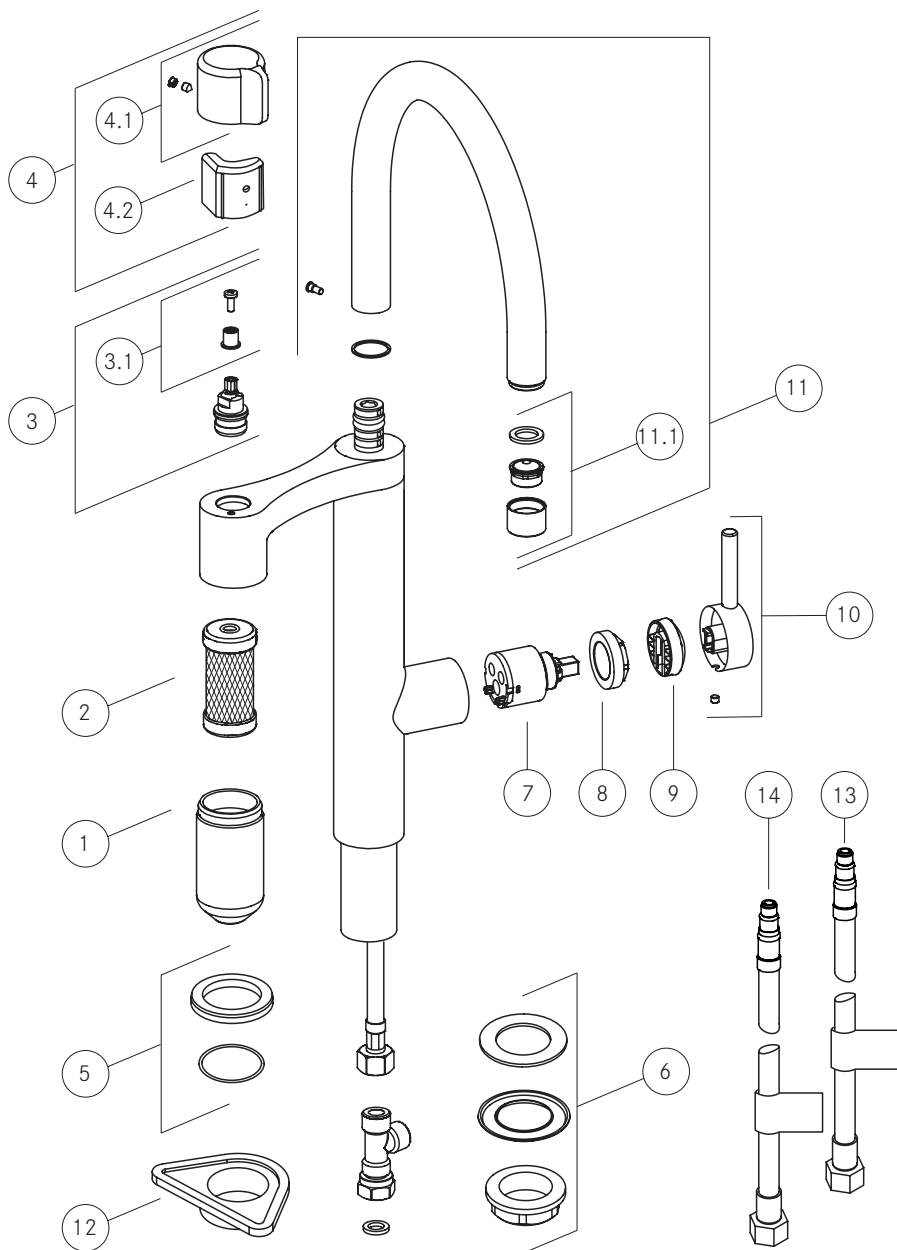

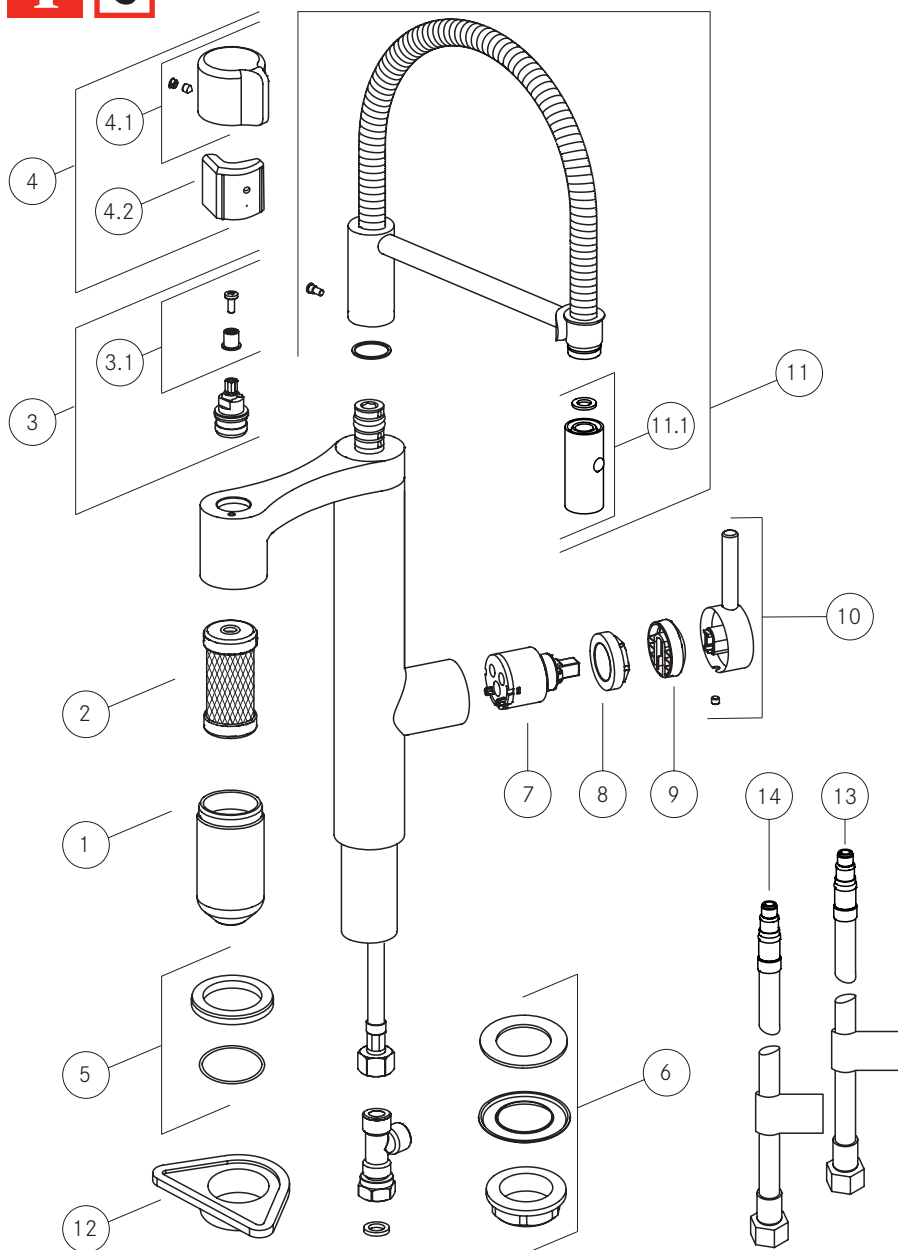



**Argentina**

Industrias Spar San Luis S.A.  
Buenos Aires 1008  
Phone +54 11 4311 7655

**Belgium**

Franke N.V.  
9400 Ninove  
Phone +32 54 310 111

**Brazil**

Franke Sistemas de  
Cozinhas do Brasil Ltda.  
89219-512 Joinville, SC  
Phone +55 47 3431 0501

**Canada**

Franke Kindred Canada Ltd.  
Midland, ON L4R 4K9  
Phone +1 866 687 7465

**China**

Franke (China) Kitchen  
Systems Co., Ltd.  
Heshan, Guangdong,  
529700  
Hotline 400 882 9898

**Czech Republic**

Franke s.r.o.  
190 00 Praha 9  
Phone +420 281 090 411

**Denmark**

Franke KS Denmark  
8520 Lystrup  
Phone +45 8624 9024

**Egypt**

Franke Kitchen Systems  
Egypt S.A.E.  
6th of October City  
Hotline 16828

**Finland**

Franke Finland Oy  
76850 Naarajärvi  
Phone +358 15 341 11

**France**

Franke France S.A.S.  
60230 Chambly  
Phone +33 130 289 400

**Germany**

Franke GmbH  
79713 Bad Säckingen  
Phone +49 7761 52 0

**Greece**

Franke Hellas S.A.  
19003 Markopoulo Attikis  
(Athens)  
Phone +30 22991 500 00

**Hong Kong SAR**

Franke Asia Hong Kong  
Causeway Bay  
Phone +852 3184 1900

**India**

Franke Faber India Pvt Ltd.  
Aurangabad - 431 136  
Phone 1800 209 3484

**Italy**

Franke S.p.A.  
37019 Peschiera del Garda  
Numero Verde 800 359 359

**Kazakhstan**

Franke Kazakhstan Ltd.  
040918 Almaty City  
Phone +7 727 297 3812

**Morocco**

Franke Kitchen System SARL  
21 000 Casablanca  
Phone +212 522 674 200

**Norway**

Franke KS Norway  
8520 Lystrup, Denmark  
Phone +47 35 566 450

**Poland**

Franke Polska Sp. z o.o.  
05-090 Raszyn  
Phone +48 22 711 6700

**Portugal**

Franke Portugal S.A.  
2735-531 Cacém  
Phone +351 21 426 9670

**Romania**

Franke Romania SRL  
Pantelimon 077145  
Phone +40 21 350 1550

**Russia**

Franke Russia GmbH  
199106 St. Petersburg  
Phone +7 812 703 1540

**Slovak Republic**

Franke Slovakia s.r.o.  
010 01 Žilina  
Phone +421 41 733 6200

**South Africa**

Franke South Africa  
Durban 4052  
Phone +27 31 450 6300

**Spain**

Franke España S.A.U.  
08174 Sant Cugat del Vallès  
Phone +34 93 565 3535

**Sweden**

Franke KS Sweden  
16867 Bromma  
Phone +46 912 405 00

**Switzerland**

Franke Küchentechnik AG  
4663 Aarburg  
Phone +41 800 583 243

**Thailand**

Franke (Thailand) Co., Ltd.  
Bangkok 10110  
Phone +66 2 013 7900

**The Netherlands**

Franke Nederland B.V.  
5700 AD Helmond  
Phone +31 492 585 111

**Turkey**

Franke Mutfak ve Banyo  
Sistemleri Sanayi ve  
Ticaret A.S.  
41400 Gebze Kocaeli  
Phone +90 262 644 6595

**Ukraine**

Franke Ukraina LLC  
02081 Kyiv  
Phone +38 044 492 0015

**United Arab Emirates**

Franke LLC  
Ras Al Khaimah  
Phone +971 7 203 4700

**United Kingdom**

Franke UK Ltd.  
Manchester M22 5WB  
Phone +44 161 436 6280

**USA**

Franke Kitchen Systems LLC  
Smyrna, TN 37167  
Phone 800 626 5771



Make  
it  
Wonderful