

FCMY 90 C WHG A FL

1. SAFETY INFORMATION

 For your own safety and to ensure proper operation of the appliance, please read this manual carefully before installation and operation. Keep these instructions together with the appliance, even if it is sold or transferred to third parties. It is important that users know all the appliance's operating and safety characteristics.

 The cables must be connected by a trained technician.

- The manufacturer shall not be considered responsible for any injury or damage caused by improper installation or use.
- The minimum safety distance between the hob and the suction hood is 650 mm (some models may be fitted at a lower height; please see the paragraph relating to working dimensions and installation).
- If the instructions for installation of the gas hob specify a distance greater than the one indicated, this must be taken into account.
- Check that the mains power supply corresponds to the one indicated on the data plate affixed inside the hood.
- The cut-out devices must be installed in the fixed system according to wiring system regulations.
- For Class I appliances, check that the domestic power supply is adequately earthed.
- Connect the hood to the flue using a pipe with a minimum diameter of 120 mm. The fumes must travel the shortest distance possible.
- All the air venting regulations must be complied with.
- Do not connect the ducting hood to flues that also carry combustion fumes (e.g. boilers, chimneys, etc.).
- If the hood is used in combination with non electric appliances (e.g. gas appliances), a sufficient level of ventilation must be guaranteed in the room to prevent any exhaust backflow. If the kitchen hood is used in combination with appliances that are not electrically powered, the negative pressure in the room must not exceed 0.04 mbar to avoid any risk of the fumes being sucked back into the room by the hood.
- The air must not be extracted through a flue that is also used as an exhaust flue for fumes from gas or other fuel powered combustion devices.
- If it is damaged, the power cable must be replaced by the manufacturer or by a service technician.
- Connect the plug to a socket that complies with current regulations and is in an accessible position.

- As regards the technical and safety measures to be taken for exhausting of fumes, it is important that the regulations set by local authorities be complied with scrupulously.

 **CAUTION:** remove the protective films before installing the hood.

- Only use screws and hardware of a sort suitable for the hood.

 **CAUTION:** failure to install the screws or fixing devices as described in these instructions may mean there is a risk of electric shocks.

- Do not look directly at the light through optical devices (binoculars, magnifying glasses...).
- Do not flambé food under the hood: you might cause a fire.
- This appliance may be used by children over the age of 8 years and by persons with limited psycho-physical and sensory abilities or with insufficient experience and knowledge, provided they are carefully supervised and instructed on how to use the appliance safely and on the dangers that it involves. Make sure that children are not allowed to play with the appliance. Cleaning and maintenance to be performed by the user must not be carried out by children, unless they are under supervision.

- Supervise children, to make sure they do not play with the appliance.

- The appliance must not be used by persons (including children) with limited psycho-physical or sensory capacities or with insufficient experience and knowledge, unless they are carefully supervised and instructed.

 Accessible parts may become extremely hot during the use of cooking appliances

- Clean and/or replace the filters after the period of time indicated (danger of fire). See the paragraph on Maintenance and cleaning.
- The room must be adequately ventilated when the hood is used simultaneously with appliances that use gas or other fuels (not applicable to appliances that only discharge air into the room).
- The symbol  on the product or on its packaging indicates that the product must not be disposed of with the normal domestic waste. The product must be disposed of at a specialist re-cycling centre for electrical and electronic components. By making sure that this product is disposed of properly, you will help prevent possible negative consequences for the environment and for health that might result from its improper disposal. For more detailed in-

formation on how to re-cycle this product, please contact your local municipal offices, local waste disposal service or the shop in which the product was purchased.

Declaration of Conformity

The manufacturer declares that this device with wireless radio functionality complies with directive 2014/53/EU.

The complete text of the EU declaration of conformity is available at the following link by searching for the product code:

“<https://www.franke.com>”

This code can be found on the label located inside the product.

Fre- quency bands	Maximum transmit- ted power
2.4 GHz	100 mW max.

2. USE

- The suction hood has been designed exclusively for domestic use, to eliminate kitchen odours.
- Never use the hood for purposes other than those for which it was designed.
- Never leave high flames under the hood when it is in operation.
- Adjust the intensity of the flame so that it is directed onto the bottom of

- the cooking pan, making sure it does not wrap around the sides.
- Deep-fryers must be kept under constant supervision when in use: the oil may catch fire if it gets too hot.

3. CLEANING AND MAINTENANCE

- The sponge-like part of the filter can be washed in the dishwasher at least once every 4 months, or more frequently if use is particularly intense. Operation is guaranteed for up to a maximum of 5 washes, after which it must be replaced (W).

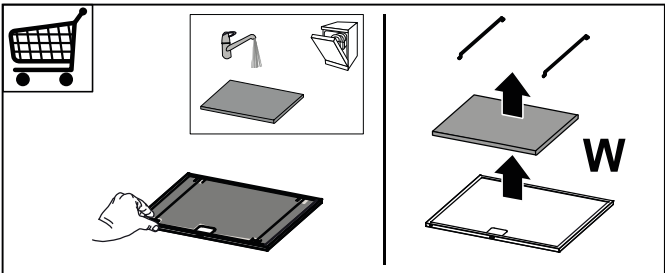

- The grease filters must be cleaned every 2 months of operation, or more frequently in the case of particularly intensive use. They can be washed in a dishwasher (Z).

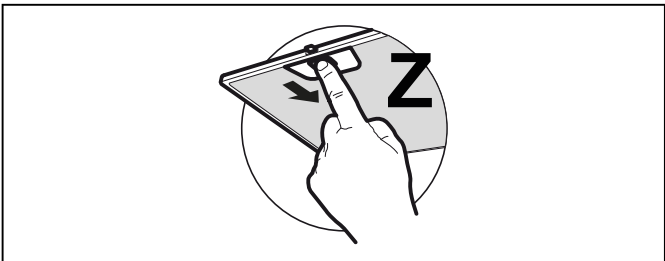

- Clean the hood using a damp cloth and neutral liquid detergent.
- Avoid using alcohol or silicone-based products to clean the inside and outside of the cooker hood.

4. CONTROLS

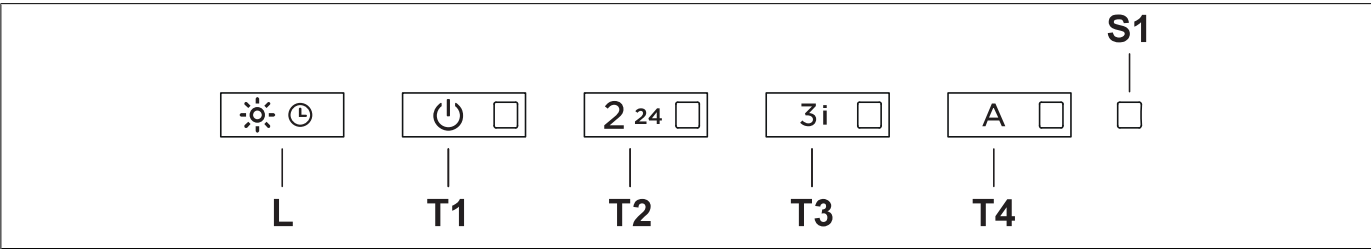

Key	Key press	Function	LED
L	Short	The lights alternate between high intensity, medium intensity (if present), off.	-
	Long press with light or motor on	Delay Function Activates/Deactivates the Delay function (automatic shutdown of the Motor and of the lighting delayed by 30"). Cannot be activated with Intensive or 24h function.	Flashing
	Long press with all loads off (motor and lights)	Connected mode coupling Before starting the procedure follow the specific instructions of the manuals of the devices to be coupled. The procedure for pairing of the hood with compatible devices (remote control) starts. Only one remote control can be paired. See the manual of the devices for details of the operations that need to be performed on these. The coupling procedure takes 2 minutes. If no devices are recognised within this time check that you have previously activated the procedure for the devices to be coupled. The maximum number of linkable devices may have been reached.	LEDs T1 and T2 flashing: coupling in progress. Upon successful completion of the procedure LEDs T1 and T2 will light up for 2 seconds.
T1	Short	Turns the motor on/off at the first speed.	Fixed
	Long press with light on	Activates/Deactivates the Activated Carbon Filters alarm .	All LEDs flash twice: alarm activated. All LEDs lit for 1 second: alarm deactivated.
	Long press with all loads off (motor and lights)	Connected mode decoupling The procedure for deleting all compatible devices previously associated with the coupling function begins.	Upon successful completion of the procedure LEDs T1 and T2 flash 5 times.
T2	Short	Turns the motor on/off at the second speed.	Fixed
	Long press with light or motor on	24h Function Activates/Deactivates the motor in the 24h Air Exchange mode, a speed that allows suction of 10 minutes every hour, for a 24-hour cycle. Cannot be activated if the Intensive or Delay modes are active.	Flashing
	Long press with all loads off (motor and lights)	Wi-Fi connection Activates/Deactivates the Wi-Fi Connection function. Note: the Wi-Fi function is automatically activated when the user requests the Wi-Fi configuration procedure.	LED S1 Flashing: connection to domestic network in progress. LED S1 Fixed: Wi-Fi connection activated.
T3	Short	Turns the motor on at the third speed.	Fixed
	Long press with light or motor on	Turns the motor on at the Intensive 1 speed. This speed is timed for 10 minutes. At the end of this time, the system automatically returns to the previously selected speed. If activated with the motor off, once the time has passed it switches to OFF mode.	Flashing
		By pressing the key again with a long press (with light or motor on), the motor starts at the Intensive 2 speed. This speed is timed for 6 minutes. At the end of this time, the system automatically returns to the previously selected speed. If activated with the motor off, once the time has passed it switches to OFF mode.	
	Long press with all loads off (motor and lights)	The Filter saturation alarm is reset.	All LEDs flash 3 times.
		Signals the saturated Metal Grease Filters alarm and the need to wash them. The alarm is activated after 100 hours of effective hood operation.	LEDs T2 and T3 lit with the hood off.
		Signals the Activated Charcoal Odour Filter saturation alarm . The alarm is activated after 200 hours of effective hood operation.	LEDs T2 and T3 flashing with the hood off.

T4	Long press with all loads off (motor and lights)	Wi-Fi configuration Activates/Deactivates the Wi-Fi set-up procedure. Before starting the procedure, use the Franke@Home App to register with the Franke IOT system. Then follow the instructions to add a new device and register the domestic router. If the procedure is not successfully completed within a few minutes, deactivate it by long pressing the key again, then make another attempt. The hood will nonetheless abandon the procedure if it is not successfully completed within 15 minutes.	LEDs T3 and T4 flashing: configuration procedure in progress. Upon successful completion of the procedure LEDs T3 and T4 will light up for 2 seconds.
Recommended device coupling sequence: 1 - Connected Mode (See remote control manual) 2 - Connected Mode Coupling (See hood manual) 3 - Remote Control-Hood Coupling (See remote control manual)			

5. FRANKE@HOME APP

The Franke@Home App is available for iOS and Android smartphones and allows remote access to all hood functions.

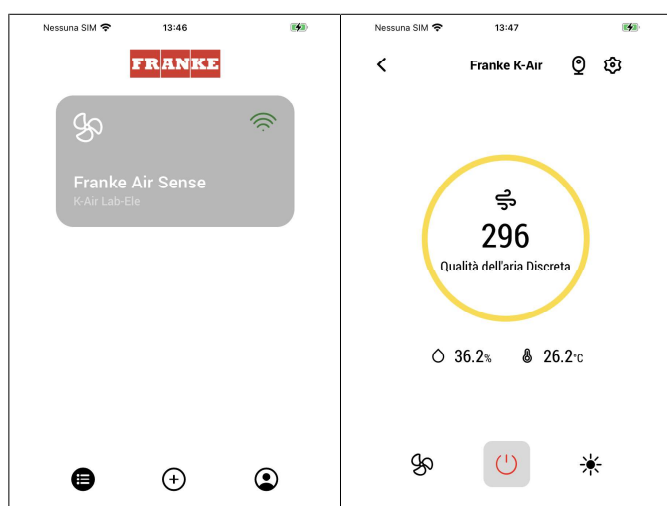

Icon	Function
	Home page
	Add new device
	User profile management
	Connected to the Wi-Fi Franke network
	Hood on/off
	Lighting system management
	Motor speed management
	Intensive Function

	24h Function
	Delay Function
	Automatic Function
	App settings management

6. REMOTE CONTROL

- This appliance may be controlled using a remote control.
- **WARNING:** the first procedure to carry out on the remote control is to activate the Connected Mode (refer to the device manual for more details).

ATTENTION: some functions can only be activated via the remote control (refer to the device manual for further details).

7. LIGHTING

- Please contact the Service Department to change it ("Please contact the service department to purchase it").
- Lamps in risk group 1 under IEC/EN62471 at a distance of 20cm and in exempt from risk group under IEC/EN62471 at a distance of 30cm.

8. LIGHTING

- Please contact the Service Department to change it ("Please contact

the service department to purchase it").



Franke UK Ltd.
MIOC, Suite 1, Styal Road
Manchester
M22 5WB
www.franke.com/gb/en/hs.html