



EN USER MANUAL

FMA 2.0 607
FMA 2.0 807
FMA 2.0 907

EN 1. SAFETY INFORMATION

i For your safety and correct operation of the appliance, read this manual carefully before installation and use. Always keep these instructions with the appliance even if you move or sell it. Users must fully know the operation and safety features of the appliance.

! The wire connection has to be done by specialized technician.

- The manufacturer will not be held liable for any damages resulting from incorrect or improper installation.
 - The minimum safety distance between the cooker top and the extractor hood is 650 mm (some models can be installed at a lower height, please refer to the paragraphs on working dimensions and installation).
 - If the instructions for installation for the gas hob specify a greater distance, this must be respected.
 - Check that the mains voltage corresponds to that indicated on the rating plate fixed to the inside of the hood.
 - Means for disconnection must be incorporated in the fixed wiring in accordance with the wiring rules.
 - For Class I appliances, check that the domestic power supply guarantees adequate earthing.
- Connect the extractor to the exhaust flue through a pipe of minimum diameter 120 mm. The route of the flue must be as short as possible.
 - Regulations concerning the discharge of air have to be fulfilled.
 - Do not connect the extractor hood to exhaust ducts carrying combustion fumes (boilers, fireplaces, etc.).
 - If the extractor is used in conjunction with non-electrical appliances (e.g. gas burning appliances), a sufficient degree of aeration must be guaranteed in the room in order to prevent the backflow of exhaust gas. When the cooker hood is used in conjunction with appliances supplied with energy other than electric, the negative pressure in the room must not exceed 0,04 mbar to prevent fumes being drawn back into the room by the cooker hood.
 - The air must not be discharged into a flue that is used for exhausting fumes from appliances burning gas or other fuels.
 - If the supply cord is damaged, it must be replaced from the manufacturer or its service agent.
 - Connect the plug to a socket complying with current regulations, located in an accessible place.
 - With regards to the technical and safety measures to be

adopted for fume discharging it is important to closely follow the regulations provided by the local authorities.

 **WARNING:** Before installing the Hood, remove the protective films.

- Use only screws and small parts in support of the hood.

 **WARNING:** Failure to install the screws or fixing device in accordance with these instructions may result in electrical hazards.

- Do not look directly at the light through optical devices (binoculars, magnifying glasses...).
- Do not flambè under the range hood; risk of fire.
- This appliance can be used by children aged from 8 years and above and persons with reduced physical, sensory or mental capabilities or lack of experience and knowledge if they have been given supervision or instruction concerning use of the appliance in a safe way and understand the hazards involved. Children shall not play with the appliance. Cleaning and user maintenance shall not be made by children without supervision.
- Children should be supervised to ensure that they do not play with the appliance.
- The appliance is not to be used by persons (including children) with reduced physical, sensory

or mental capabilities, or lack of experience and knowledge, unless they have been given supervision or instruction.

 Accessible parts may become hot when used with cooking appliances.

- Clean and/or replace the Filters after the specified time period (Fire hazard). See paragraph Care and Cleaning.
- There shall be adequate ventilation of the room when the range hood is used at the same time as appliances burning gas or other fuels (not applicable to appliances that only discharge the air back into the room).
- The symbol  on the product or on its packaging indicates that this product may not be treated as household waste. Instead it shall be handed over to the applicable collection point for the recycling of electrical and electronic equipment. By ensuring this product is disposed of correctly, you will help prevent potential negative consequences for the environment and human health, which could otherwise be caused by inappropriate waste handling of this product. For more detailed information about recycling of this product, please contact your local city office, your household waste

disposal service or the shop where you purchased the product.

2. USE

- The extractor hood has been designed exclusively for domestic use to eliminate kitchen smells.
- Never use the hood for purposes other than for which it has been designed.
- Never leave high naked flames under the hood when it is in operation.
- Adjust the flame intensity to direct it onto the bottom of the pan only, making sure that it does not engulf the sides.
- Deep fat fryers must be continuously monitored during use: overheated oil can burst into flames.

3. CARE AND CLEANING

- The Activated charcoal filter is not washable and cannot be regenerated, and must be replaced approximately every 4 months of operation, or more frequently for particularly heavy usage (**W**).

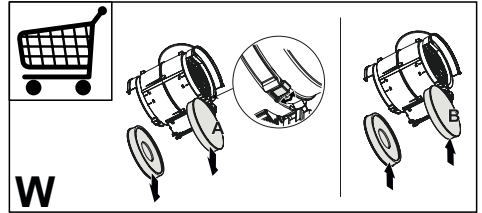

- The Grease filters must be cleaned every 2 months of operation, or more frequently for particularly heavy usage, and can be washed in a dishwasher (**Z1-Z2**).

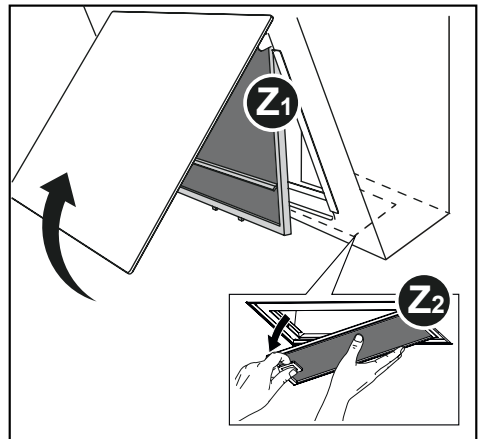

- Clean the hood using a damp cloth and a neutral liquid detergent.

4. CONTROLS

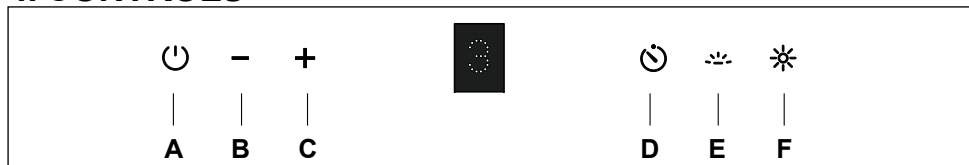

Button	Function	Display
A	Press briefly to turn the Motor on (speed one)/off.	Shows the speed set.
	Press and hold the button for approximately 2 seconds, with the filter alarm active, to reset the alarm.	Leds C + D flash 3 times. When the procedure terminates, the indication shown previously turns off: F - 1 + (pause) + F - 1 Indicates that it is necessary to wash the metal grease filters. The alarm is triggered after the Hood has been operating for 100 working hours. F - 2 + (pause) + F - 2 Indicates that it is necessary to change the activated charcoal filters and wash the metal grease filters at the same time. The alarm is triggered after the Hood has been operating for 200 working hours.
B	Decreases the working speed.	Shows the speed set.
	With the motor turned off, press and hold the button for approximately 2 sec. to activate/deactivate the keyboard lock, allowing the glass to be cleaned without activating any of the functions by mistake. It deactivates automatically after 2 minutes.	All the Leds flash every half a second.
C	Increases the working speed in cycle...: 1 - 2 - 3 - Intensive	Shows the speed set 1 - 2 - 3 .
	Intensive: Timed to run for 6 minutes, after which it returns to Speed 3. They are disabled by pressing A or B .	Shows “ animation “ on the display.
D	Press briefly to enable/disable the Delay , automatic switch-off of the Motor and Lighting system with a 30 minute delay. It can also be deactivated by pressing A .	On/Off + “ animation “ on the display.
	Press and hold the button for approx. 2 sec. to Activate/Deactivate the motor in 24H Air Circulation mode, a speed that allows ducting for 10 minutes every hour, for a 24 hour cycle. It can also be deactivated by pressing A .	Flashing + “ animation “ on the display.
E	Turns the lighting system on and off at medium intensity.	On/Off
F	Turns the lighting system on and off at maximum intensity.	On/Off

5. LIGHTING

- For replacement contact technical support (“To purchase contact technical support”).



Franke S.p.a.
Via Pignolini, 2
37019 Peschiera del Garda (VR)
www.franke.it