



Istruzioni per l'uso e l'installazione

Cappa



Instructions for use and installation

Cooker Hood



Mode d'emploi et installation

Hotte de Cuisine



Bedienungsanleitung und Installation

Dunstabzugshaube



Kullanım ve montaj talimatları

Davumbaz

ATMOS 604
ATMOS 904
ATMOS 1204

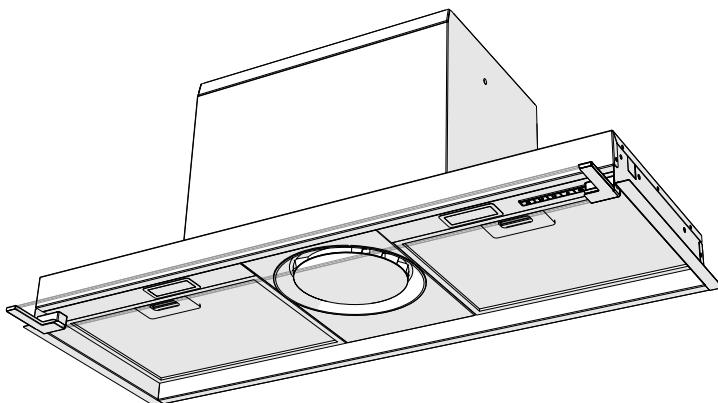

INDICE

IT

STEAM OFF SYSTEM.....	3
CONSIGLI E SUGGERIMENTI.....	4
CARATTERISTICHE.....	7
MONTAGGIO	8
INSTALLAZIONE	11
USO	13
MANUTENZIONE	14

INDEX

GB

STEAM OFF SYSTEM.....	15
RECOMMENDATIONS AND SUGGESTIONS	16
CHARACTERISTICS	19
ASSEMBLY.....	20
INSTALLATION.....	23
USE	25
MAINTENANCE	26

SOMMAIRE

FR

STEAM OFF SYSTEM.....	27
CONSEILS ET SUGGESTIONS.....	28
CARACTÉRISTIQUES	31
MONTAGE	32
INSTALLATION	35
UTILISATION.....	37
ENTRETIEN	38

INHALTSVERZEICHNIS

DE

STEAM OFF SYSTEM.....	39
EMPFEHLUNGEN UND HINWEISE	40
CHARAKTERISTIKEN	43
MONTAGE.....	44
INSTALLATION.....	47
BEDIENUNG.....	49
WARTUNG	50

İÇERİKLER

TR

STEAM OFF SYSTEM.....	51
ÖNERİ VE TAVSİYELER	52
ÜRÜN ÖZELLİKLERİ	55
MONTAJ	56
KURULUM	59
KULLANIM.....	61
BAKIMI	62



± 20Kg

4x(Ø4x20)
20x(Ø4x6)

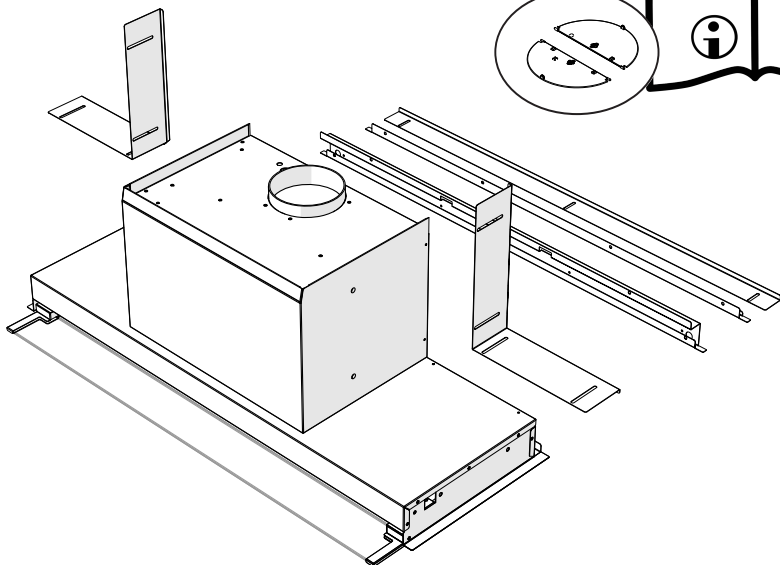
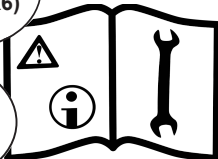
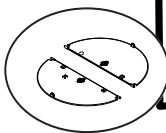

STEAM OFF SYSTEM

EXCLUSIVE, CONDENSATION-FREE COMFORT

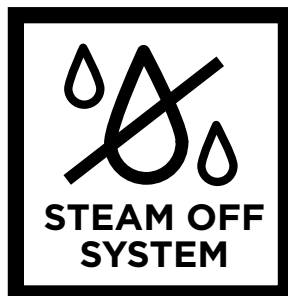

- In induction hobs, the thermal differential created between the hot part adjacent to the cooking top and the cooler air under the extractor side of the hood causes condensation and dripping that no one had yet managed to solve.

Steam dispersion also tends to involve the surrounding environment and the structural elements of the kitchen, such as the doors and bases of the wall units.

All this is eliminated with the Steam Off System.

A HOOD THAT “BREATHES”

- Controlled air jets released in a helical shape and with variable geometry create two vortices that control the rise of smoke and steam. With Steam Off System, therefore, the hood not only sucks in but also emits air jets that create a vortical motion and acceleration and help to convey and capture the steam. This puts an end to condensation and its depositing under and around the hood!

RECOMMENDATIONS AND SUGGESTIONS

- △ The Instructions for Use apply to several versions of this appliance. Accordingly, you may find descriptions of individual features that do not apply to your specific appliance.

INSTALLATION

- The manufacturer will not be held liable for any damages resulting from incorrect or improper installation.
- The minimum safety distance between the cooker top and the extractor hood is 650 mm (some models can be installed at a lower height, please refer to the paragraphs on working dimensions and installation).
- Check that the mains voltage corresponds to that indicated on the rating plate fixed to the inside of the hood.

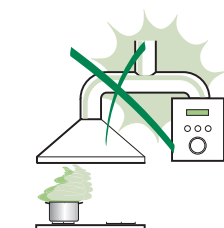

- For Class I appliances, check that the domestic power supply guarantees adequate earthing. Connect the extractor to the exhaust flue through a pipe of minimum diameter 120 mm. The route of the flue must be as short as possible.
- Do not connect the extractor hood to exhaust ducts carrying combustion fumes (boilers, fireplaces, etc.).

- If the extractor is used in conjunction with non-electrical appliances (e.g. gas burning appliances), a sufficient degree of aeration must be guaranteed in the room in order to prevent the backflow of exhaust gas. The kitchen must have an opening communicating directly with the open air in order to guarantee the entry of clean air.

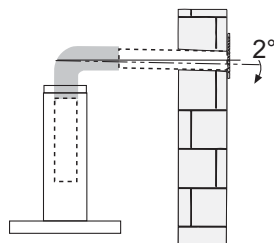

When the cooker hood is used in conjunction with appliances supplied with energy other than electric, the negative pressure in the room must not exceed 0,04 mbar to prevent fumes being drawn back into the room by the cooker hood.

- In the event of damage to the power cable, it must be replaced by the manufacturer or by the technical service department, in order to prevent any risks.

- If the instructions for installation for the gas hob specify a greater distance specified above, this has to be taken into account. Regulations concerning the discharge of air have to be fulfilled.
- Use only screws and small parts in support of the hood.

Warning: Failure to install the screws or fixing device in accordance with these instructions may result in electrical hazards.

- Connect the hood to the mains through a two-pole switch having a contact gap of at least 3 mm.

USE

- The extractor hood has been designed exclusively for domestic use to eliminate kitchen smells.
- Never use the hood for purposes other than for which it has been designed.
- Never leave high naked flames under the hood when it is in operation.
- Adjust the flame intensity to direct it onto the bottom of the pan only, making sure that it does not engulf the sides.
- Deep fat fryers must be continuously monitored during use: overheated oil can burst into flames.
- Do not flambé under the range hood; risk of fire.
- This appliance can be used by children aged from 8 years and above and persons with reduced physical, sensory or mental capabilities or lack of experience and knowledge if they have been given supervision or instruction concerning use of the appliance in a safe way and understand the hazards involved. Children shall not play with the appliance. Cleaning and user maintenance shall not be made by children without supervision.

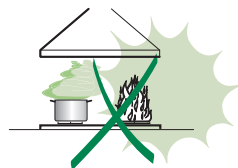

- **“CAUTION:** Accessible parts may become hot when used with cooking appliances.”

MAINTENANCE

- Switch off or unplug the appliance from the mains supply before carrying out any maintenance work.
- Clean and/or replace the Filters after the specified time period (Fire hazard).
- The Grease filters must be cleaned every 2 months of operation, or more frequently for particularly heavy usage, and can be washed in a dishwasher.
- The Activated charcoal filter is not washable and cannot be regenerated, and must be replaced approximately every 4 months of operation, or more frequently for particularly heavy usage.
- "Failure to carry out cleaning as indicated will result in a fire hazard".
- Clean the hood using a damp cloth and a neutral liquid detergent.



The symbol  on the product or on its packaging indicates that this product may not be treated as household waste. Instead it shall be handed over to the applicable collection point for the recycling of electrical and electronic equipment. By ensuring this product is disposed of correctly, you will help prevent potential negative consequences for the environment and human health, which could otherwise be caused by inappropriate waste handling of this product. For more detailed information about recycling of this product, please contact your local city office, your household waste disposal service or the shop where you purchased the product.

CHARACTERISTICS

Dimensions

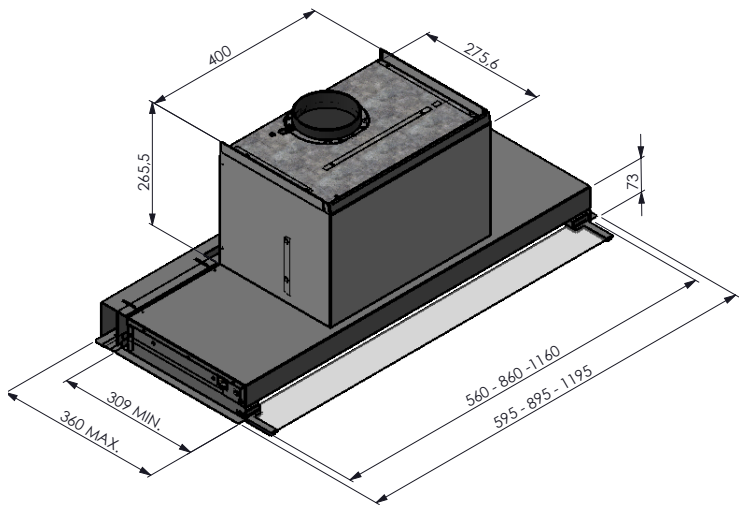
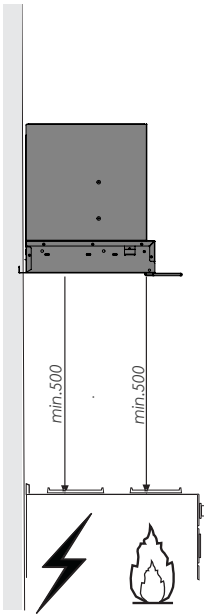
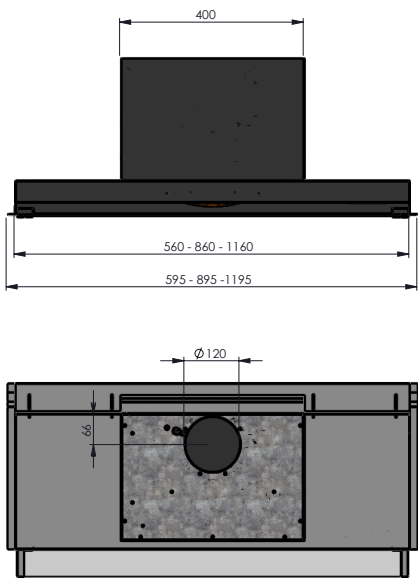

ASSEMBLY

- The Hood can be directly installed in wall units deep 310mm
- For deeper wall units, you can use 3 spacers supplied

Wall Unit D	310	320	340	360
spacers	-	A	A+C	A+B+C

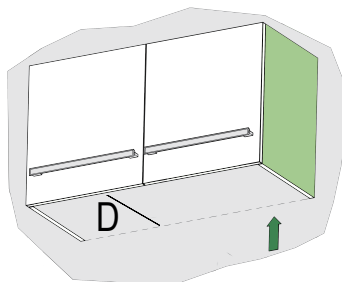
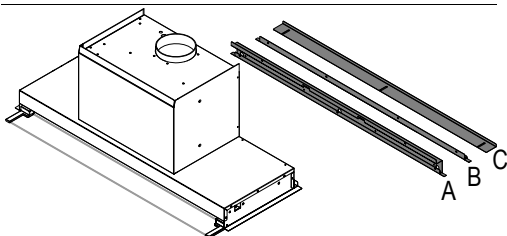

Wall Unit 320 mm

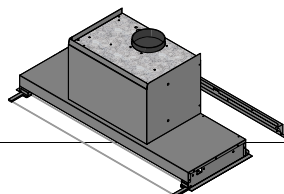

- To fit the Hood in wall units deep 320mm, use the spacer A
- Mount the spacer as shown in the figure using the screws (Ø4x6)
- The number of the screws depends on the length of the Hood (56/86/116)

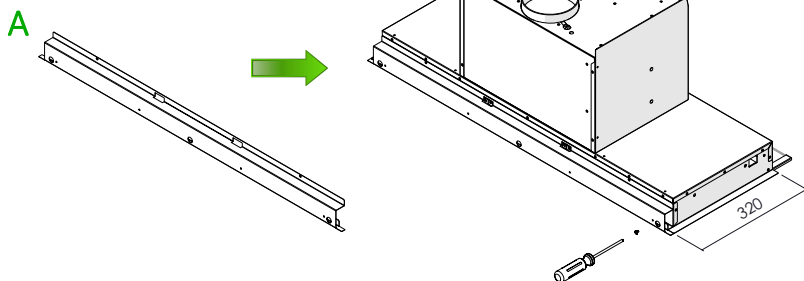

Wall Unit 340 mm

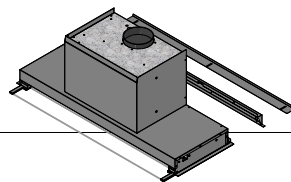

- To fit the Hood in wall units deep 340mm, use the spacers A and C
- Mount the spacer A (see pag.16a); the spacer C grabs the A, then fix it as shown in the figure with screws ($\varnothing 4 \times 6$)
- The number of the screws depends on the lenght of the Hood (56/86/116)

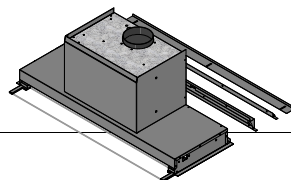
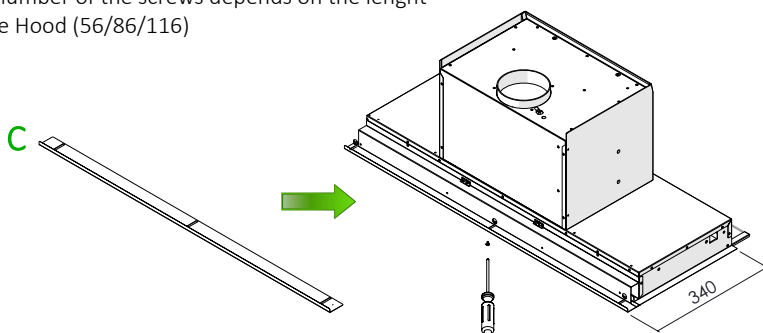

Wall Unit 360 mm

- To fit the Hood in wall units deep 360mm, use the spacers A, B and C
- Mount the spacer A (see pag.16a); then the spacer B as shown in the figure with screws ($\varnothing 4 \times 6$)
- In closing, mount the spacer C with screws ($\varnothing 4 \times 6$)
- The number of the screws depends on the lenght of the Hood (56/86/116)

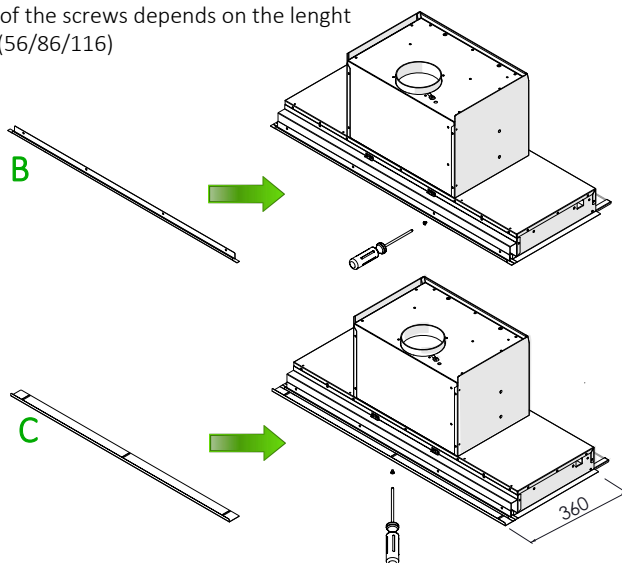

SPACERS ASSEMBLY X, Y

- Mount the spacers as shown in the figure using the screws (Ø4x6)

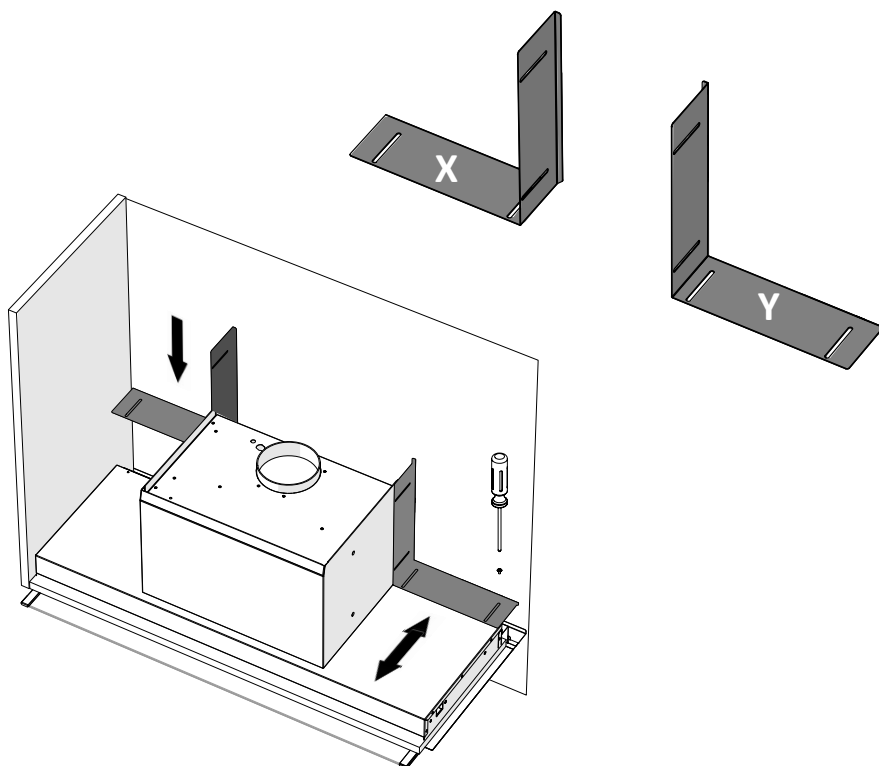

INSTALLATION

FIXING IN WALL UNIT

- ONLY mod. 560mm: it is required to remove the panels before proceeding.

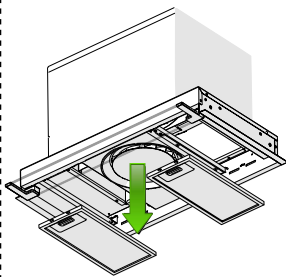

1) remove the filters

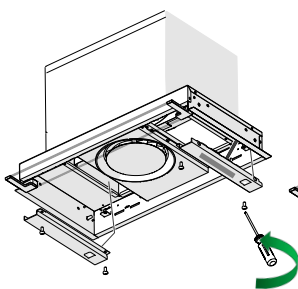

2) remove the screws 4x (M4x10)

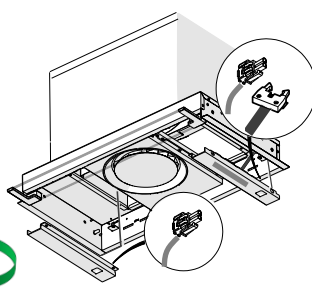

3) disconnect the cables

- Arrange the Hood in the wall unit, without filters

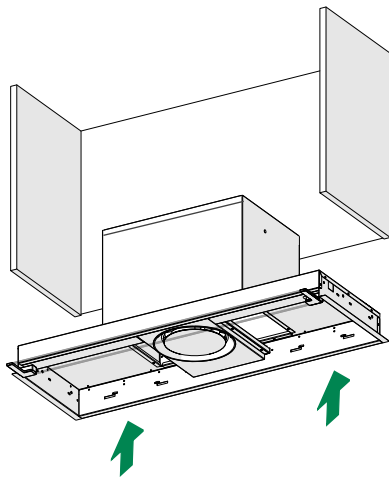

- Fix it with the screws supplied 4x(Ø4x20)

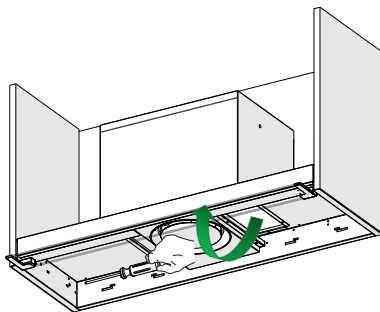

- ONLY mod. 560mm: refit the panels again [3) -> 2) -> 1)]

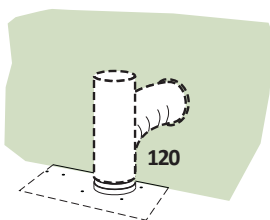

DUCTED VERSION AIR EXHAUST SYSTEM

When installing the ducted version, connect the hood to the chimney using either a flexible or rigid pipe \varnothing 120 mm.

- Fix the pipe in position using sufficient pipe clamps (not supplied).
- Remove any activated charcoal filters.

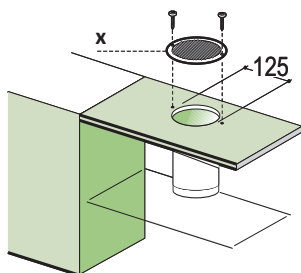

RECIRCULATION VERSION AIR OUTLET

- Cut a hole \varnothing 125 mm in any shelf that may be positioned over the hood.
- Connect the flange to the outlet on the shelf over the hood by using a flexible or rigid pipe \varnothing 120 mm.
- Fix the pipe in position using sufficient pipe clamps.
- Fix the air outlet grid **x** on the recirculation air outlet. This material is not supplied.
- Ensure that the activated charcoal filters have been inserted.

ELECTRICAL CONNECTION

- The mains voltage must match that given on the ratings label inside the hood itself. If the hood has a power plug, connect the hood to an easily accessible regulatory power socket. If it does not (direct connection to the mains), or the socket is not easily accessible, install a two-pole regulatory switch to enable total disconnection from the mains in case of category III overvoltage, as required by the installation regulations.









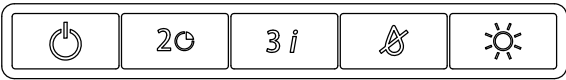

! LED Replacement

- For replacement contact technical support.

USE

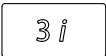
Control panel



	<ul style="list-style-type: none">• Short pression: Turns the motor on at speed one, the relevant LED turns on.• Long pression: all functions turn off (excluding lights, if lit).
	<ul style="list-style-type: none">• Short pression: Motor at the second speed, the relevant LED turns on.• Long pression: Push this button to set up the timer of 5 minutes at the using speed. After 5 minutes the cooker hood will switch off automatically (motor, SOS and lights).• The timer can not be activated for intensive speed.• To reset the timer press the button  for 2".
	<ul style="list-style-type: none">• Short pression: Motor at the third speed, the relevant LED turns on.• Long pression: turns the Motor on at the intensive speed for 7'. The LED flashes.• At the end of this time, the system returns to the speed that was set before.• It is deactivated by pressing the same button, or any speed button or the button  to turn off the motor.
	<ul style="list-style-type: none">• Turns the STEAM_SYSTEM on/off (ONLY AFTER STARTING THE REGULAR ASPIRATION); the relevant LED turns on. THE SYSTEM TURNS OFF ALSO WHEN THE MOTOR TURNS OFF.
	<ul style="list-style-type: none">• Turns the lights ON/OFF and also the relevant LED.

FILTERS MAINTENANCE

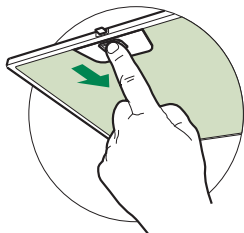

Grease filters

CLEANING METAL SELF- SUPPORTING GREASE FILTERS

- The filters must be cleaned every 2 months of operation, or more frequently for particularly heavy usage, and can be washed in a dishwasher.
- Remove the filters one at a time by pushing them towards the back of the group and pulling down at the same time.
- Wash the filters, taking care not to bend them. Allow them to dry before refitting.
- When refitting the filters, make sure that the handle is visible on the outside.

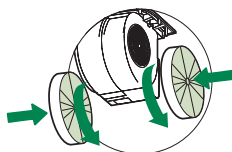
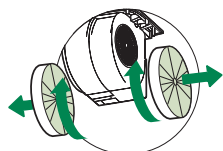

Activated charcoal filter (Recirculation version)

REPLACING THE ACTIVATED CHARCOAL FILTER

- The filter is not washable and cannot be regenerated, and must be replaced approximately every 4 months of operation, or more frequently for particularly heavy usage.
- Remove the metal grease filters.
- Remove the saturated activated carbon filter by releasing the fixing hooks.
- Fit the new carbon filter by hooking it into its seating.
- Refit the metal grease filters.

SoS MAINTENANCE

- The SoS must be cleaned every 2 months of operation, or more frequently for particularly heavy usage.
- Remove the grease filters.
- Remove the SoS in his metallic shell, unscrewing the 4 screws.
- Clean the SoS with a damp cloth and reassemble.

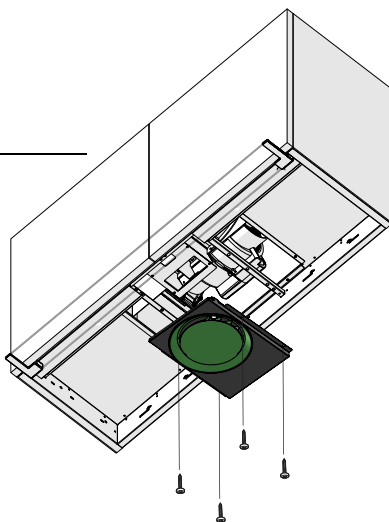
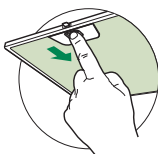



Franke S.p.a.
Via Pignolini,2
37019 Peschiera del Garda (VR)
www.franke.it