

Drawing No.	0056-216301	Revision	
Drawn Date	11.07.2017		
These drawings and specifications are the property of Franke Technology and Trademark Ltd. and shall not be reproduced, copied or transferred to any third party without the prior written permission of Franke Technology and Trademark Ltd., Hergiswil, Switzerland			

Franke Küchentechnik AG
CH-4663 Aarburg
Phone: +41 62 787 31 31
Internet : www.franke.com

BCX 251 LHD SI

installing document

Sheet	Sheets
1	6

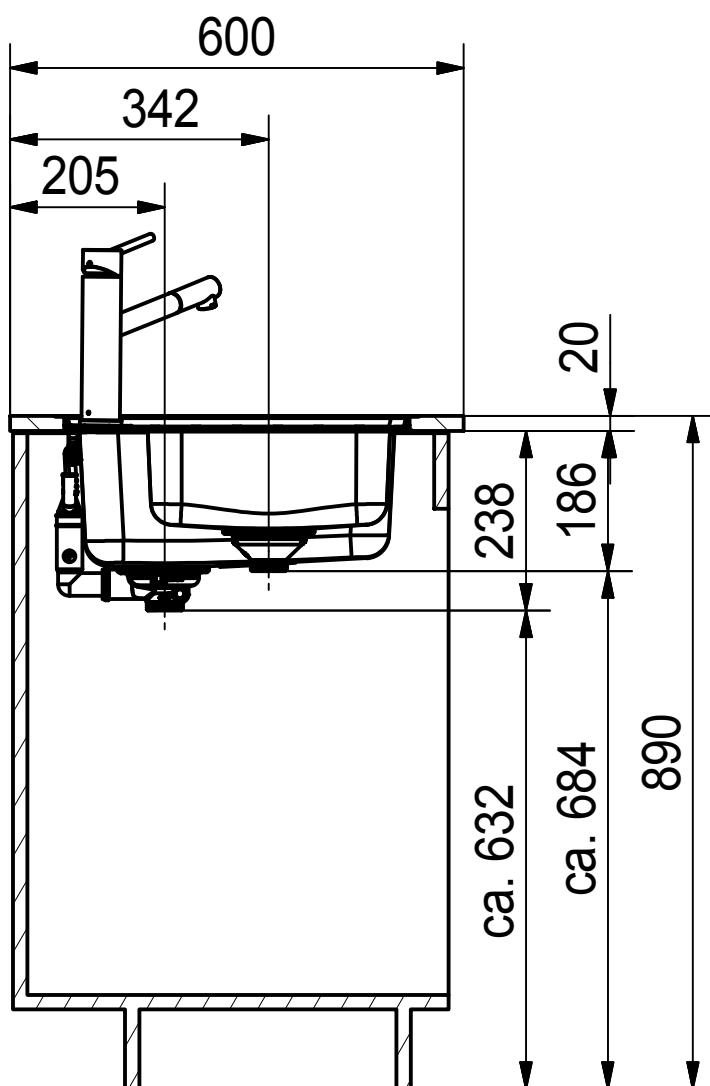

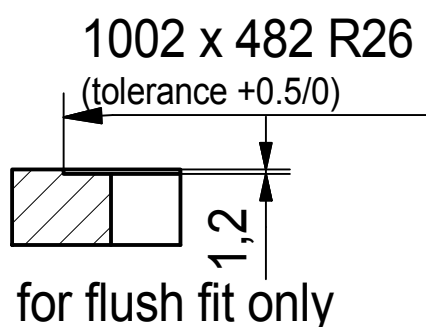
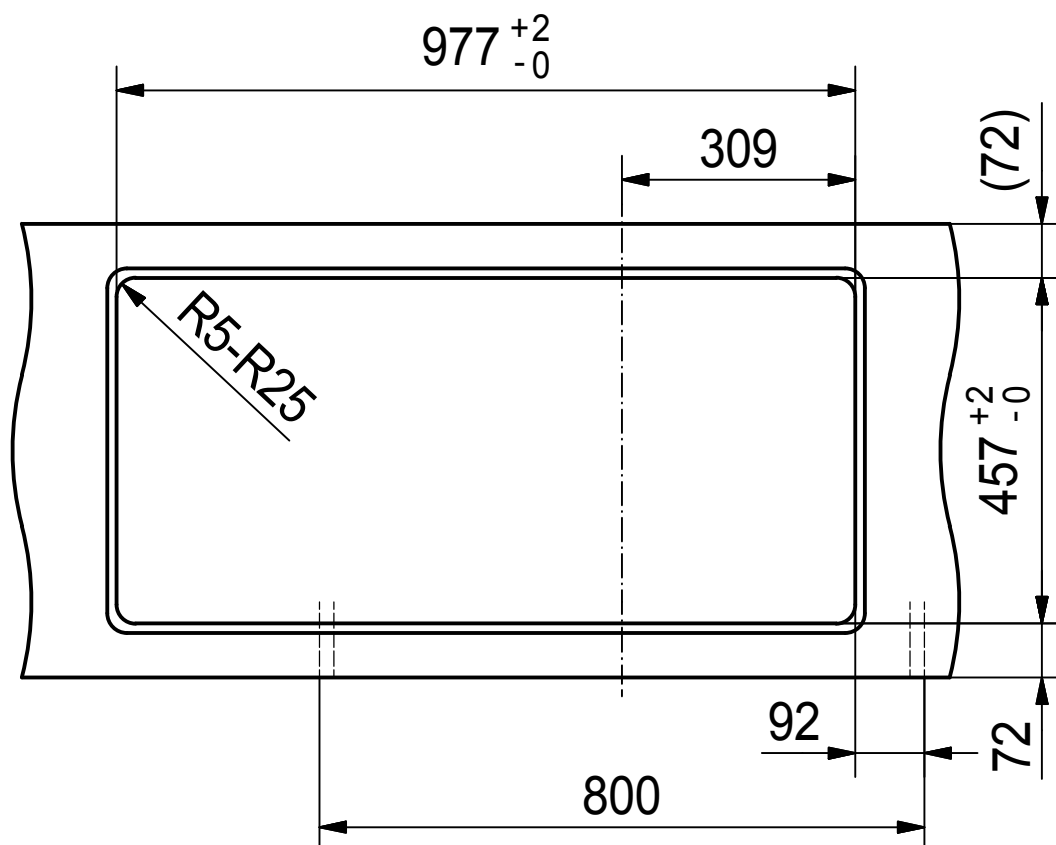

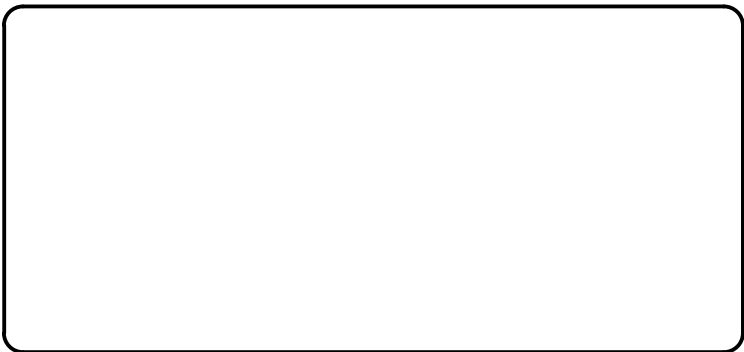

Drawing No.	0056-216301	Revision	
Drawn Date	11.07.2017		
These drawings and specifications are the property of Franke Technology and Trademark Ltd. and shall not be reproduced, copied or transferred to any third party without the prior written permission of Franke Technology and Trademark Ltd., Hergiswil, Switzerland			

Franke Küchentechnik AG
CH-4663 Aarburg
Phone: +41 62 787 31 31
Internet : www.franke.com

BCX 251 LHD SI

installing document

Sheet	Sheets
4	6

DT

Technical drawing of the BCX 251 LHD SI sink, showing dimensions and layout. The drawing includes the following dimensions and features:

- Overall width: 1000
- Overall height: 480
- Left side height: 320
- Right side height: 415
- Top left corner radius: R25
- Top right corner radius: R50
- Drain diameter: Ø35
- Drain offset from right edge: 448
- Drain offset from left edge: 60
- Drain offset from bottom edge: 170
- Drain offset from right edge: 360
- Drain offset from bottom edge: 25
- Drain offset from right edge: 33

Drawing No.	0056-216301	Revision		Franke Küchentechnik AG CH-4663 Aarburg Phone: +41 62 787 31 31 Internet : www.franke.com	BCX 251 LHD SI installing document	Sheet	Sheets
Drawn Date	11.07.2017					5	6
These drawings and specifications are the property of Franke Technology and Trademark Ltd. and shall not be reproduced, copied or transferred to any third party without the prior written permission of Franke Technology and Trademark Ltd., Hergiswil, Switzerland							

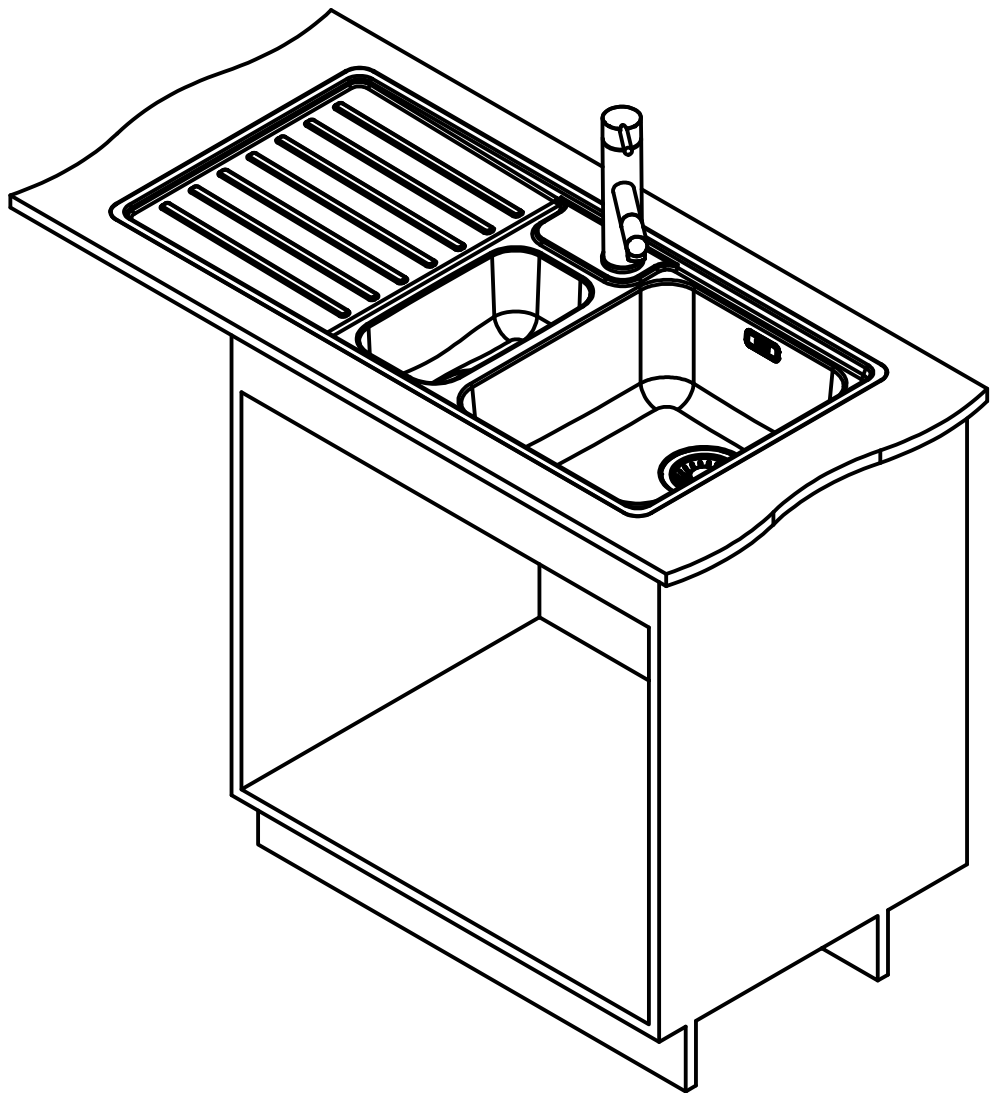

Drawing No.	0056-216301	Revision	
Drawn Date	11.07.2017		
<small>These drawings and specifications are the property of Franke Technology and Trademark Ltd. and shall not be reproduced, copied or transferred to any third party without the prior written permission of Franke Technology and Trademark Ltd., Hergiswil, Switzerland</small>			

Franke Küchentechnik AG
 CH-4663 Aarburg
 Phone: +41 62 787 31 31
 Internet : www.franke.com

BCX 251 LHD SI

installing document

Sheet	Sheets
6	6