

■■■ Installation instructions for Franke faucet with spout

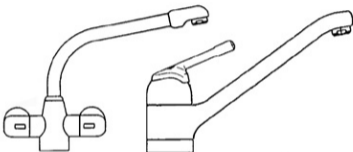
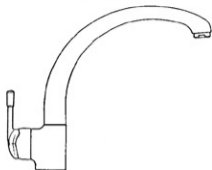

■ Technology

■ Quality

■■■ **Limited Warranty.** Franke, Inc., will replace, without charge, any Franke faucet or component part, proven to be defective within one year from date of purchase, to the original owner, providing it has been installed in accordance with our installation instructions, used as recommended, and not scratched or scuffed due to corrosive or abrasive cleaning agents.

■■■ Franke, Inc., reserves the right to inspect such installation prior to the actual replacement of the faucet or component part.

■■■ Replacement excludes freight transportation and any labor re-installation costs.

■■■ This warranty covers only the faucet/component parts used in normal residential applications. Scuffs and scratches caused by improper installation or accidental damage are not covered by warranty.

■■■ **Design.** These faucets are available in chrome and a selection of epoxy colors to match Franke accessories. The elegant high rising swan's neck spout has a high clearance from sinktop level giving plenty of room to fill or wash pots. This clearance is particularly important with accessorized sinks such as Franke where accessories bring the bowl to countertop level when in use.

■■■ **Care of finish.** These faucets have been carefully manufactured. The chrome or coloured surfaces will maintain their appearance for a long time, provided they are cleaned using a soft cloth, water and soap. NEVER use an abrasive cleanser (liquid or powder) nor any scouring pad on this faucet.

■■■ **Technical data**

Maximum water pressure:	75 PSI
Maximum hot water temperature:	175° F
Recommended hot water temperature:	150° F
Tailpipe connections:	3/8" O.D.

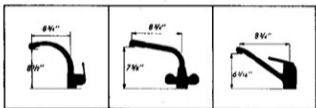

■ Design

■■■ Ceramic disc cartridges, as used on single lever models, are covered by a five year warranty from date of purchase.

■■■ In event of a replacement claim, owner will be required to provide proof of purchase.

■■■ It is recommended that your faucet be installed by a registered plumber. Please read these instructions before installing or using this faucet. This instruction sheet should be left with consumer for future reference.

■■■ Spare parts should be ordered from your local dealer.

■■■ Dimensions and specification subject to change without notice.

■■■ Franke Disc Side Lever

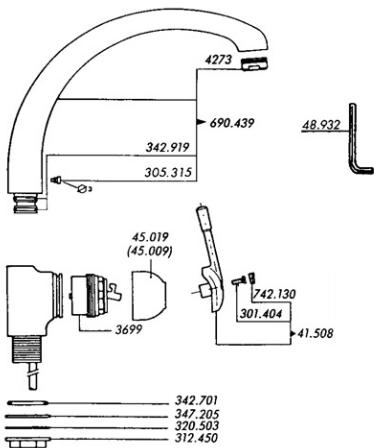

■■■ Franke Disc Top Lever

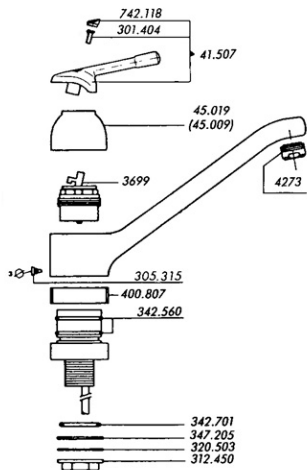

■■■ Franke Diskette

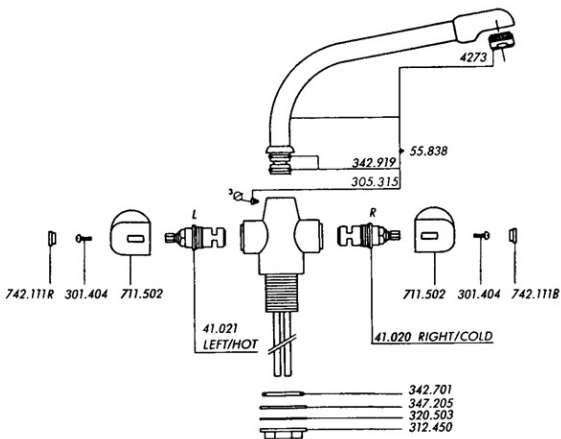

**■■■ Attention. Before** installing the faucet **SUPPLY LINES MUST BE FLUSHED** to remove scale, solder or other impurities and prevent them from entering the faucet.

### ■■■ Installation

(if top mount lever, skip to step 6).

- 1) Take the spout from the box. Remove protective cap from spout.
- 2) Remove faucet body from box. Remove Allen key (790.203) from box.
- 3) Using Allen key retract set screw (300.009) so that it does not protrude into "ID" of faucet base while taking care not to lose set-screw.
- 4) Next, insert spout into body by slowly rotating and pushing until the spout clicks into the body. The o-rings have been lubricated to aid in installation and prevent breakage. If the spout will not click into place, recheck to make sure the set screw has been retracted and is not interfering with assembly.
- 5) Now secure spout by tightening set screw.
- 6) Remove nut (312.450), metal friction washer (320.503) and flat washer (347.205).
- 7) Insert faucet through sink hole (or through base plate) with rubber o-ring (342.701) on top.
- 8) Tighten faucet down to sink. Flat washer first then metal friction washer and hexagon nut.
- 9) Connect the faucet supply tailpipes by their respective code: red spot / hot water-blue spot / cold water.

**■■■ Maintenance on mechanisms.** Under normal operating conditions, Franke faucet do not require any maintenance. They are unaffected by scaling or corrosion.

**■■■ The cartridges on Franke Disc can, however, be disassembled for maintenance in the following manner:**

- 1) Turn off the water at supply line connections.
- 2) Remove the blue/red insert with a screwdriver.
- 3) Remove screw, lever and the protective cap (45.019).
- 4) Unscrew, the nut holding the cartridge (3699) and remove the entire cartridge from the body.
- 5) Clean the cartridge and rinse out the body.
- 6) Reassemble by reversing the disassembly procedure, taking special care that the position pin of the cartridge is correctly located in its cavity.

**■■■ The valve on Franke Diskette can, however, be disassembled in the following manner:**

- 1) Turn off the water at supply line connection.
- 2) Using a screwdriver, remove the coloured insert (742.111) on the side of the handle. Unscrew (301.404) and remove the handle (711.502).
- 3) Then unscrew the valve and remove it.
- 4) Clean the valve or replace it when needed.
- 5) Reassemble by reversing the disassembly procedure taking good care that the body is clean.
- 6) Take good care that the rubber seal and the brass ring are well positioned on base of valve. The handles' wings should be aligned at 45 degrees when in back stops.

**■■■ Aerator cleaning:** If water outlet is clogged with stain deposit or impurities, you can unscrew the aerator plate to clean it.

### ■■■ Maximum Temperature Limitation

Readjust if necessary.

**NOTE:** Before making any adjustments, note that the arrow on the cartridge is aligned with the 0 (the number zero) on the transparent ring.

Device for energy saving and safeguarding against scalds.

- 1) Place the lever in the "cold" position.
- 2) Remove the blue/red insert with a screwdriver.
- 3) Remove screw, lever and the protective cap.
- 4) Unsnap the transparent stop ring. (See Fig. 2.)
- 5) Reset the stop ring to the desired temperature limit.

**Top mount lever:** While looking down at the faucet, locate the blue arrow (underneath the zero before removing transparent ring). Rotate the temperature ring counter-clockwise to the desired number setting; 1 through 9.

**Side lever:** With the faucet in the upright position, locate the blue arrow (underneath the zero before removing transparent ring) which will be in the 12 o'clock position. Rotate the temperature ring counter-clockwise to the desired number setting; 1 through 9.

- 6) Move the lever into the "hot" position and check the temperature.
- 7) Replace the cap, the lever and the blue/red insert.

Note: Since the maximum temperature of the mixed water is dependent on the variations of inlet water pressure and temperatures, an exact and continuous temperature cannot be guaranteed. To reduce hot water scalding, it is recommended to consider these factors.

Fig. 2.

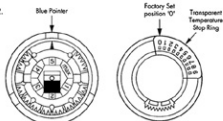

### ■■■ Maximum Flow Rate Adjustment

**■■■ Device for water saving and safeguarding against splashing.**

- 1) Remove the blue/red insert with a screwdriver.
- 2) Remove the screw, lever, and the protective cap.
- 3) Note the position of the transparent temperature stop ring and remove. (See Fig. 3.)
- 4) Pull off the green flow rate stop (factory adjusted to max.).
- 5) Using the percentages shown below, as a guide, replace green flow rate stop placing the corresponding setting number at lever pivot point.

Fig. 3.

