

DF

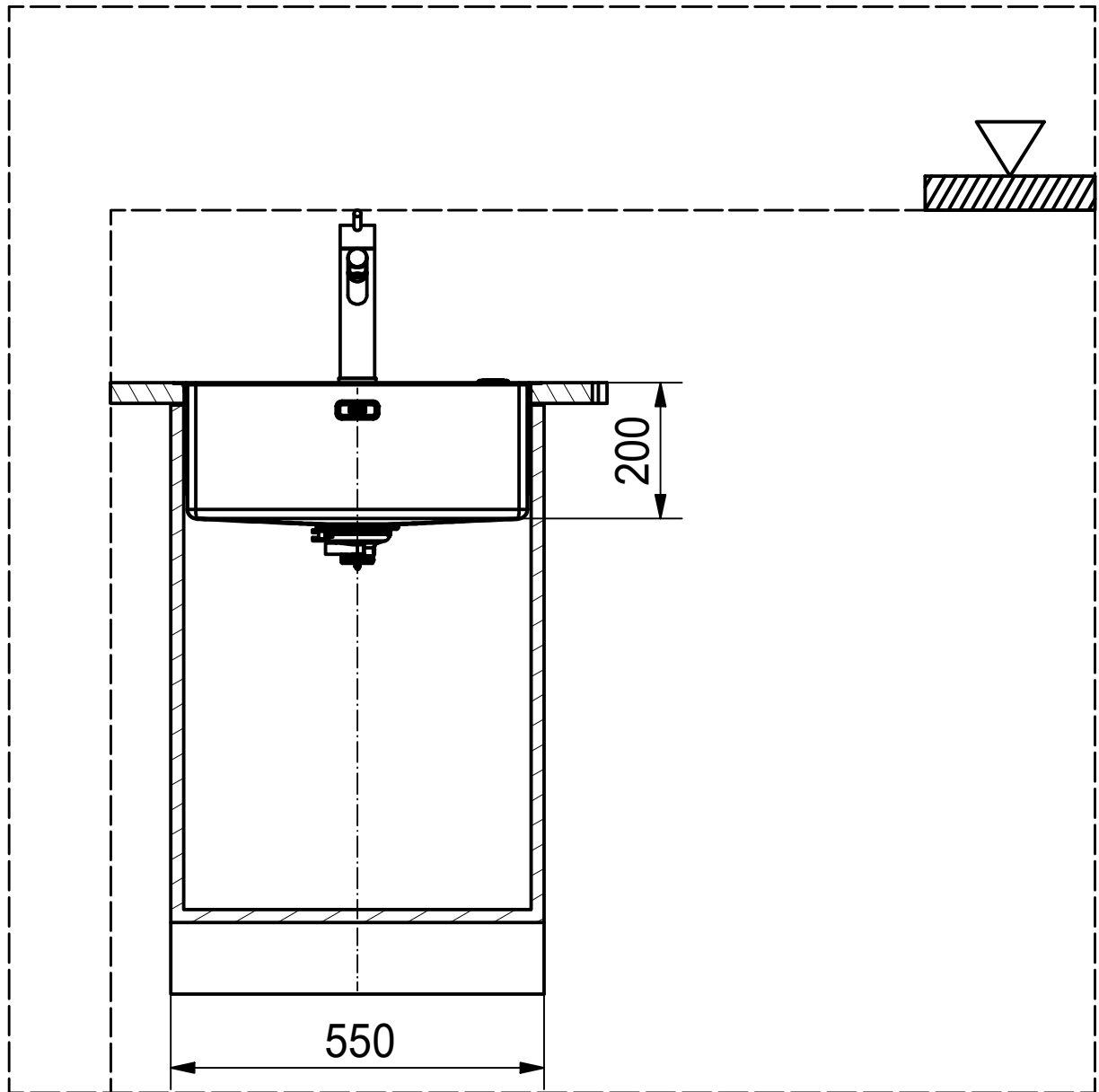

Drawing No.	20198784_02	Revision	
Drawn Date	16.11.2020		
<small>These drawings and specifications are the property of Franke Technology and Trademark Ltd. and shall not be reproduced, copied or transferred to any third party without the prior written permission of Franke Technology and Trademark Ltd., Hergiswil, Switzerland</small>			



BXM 210/110-50 SI
Installing document

Sheet	Sheets
1	11

DS

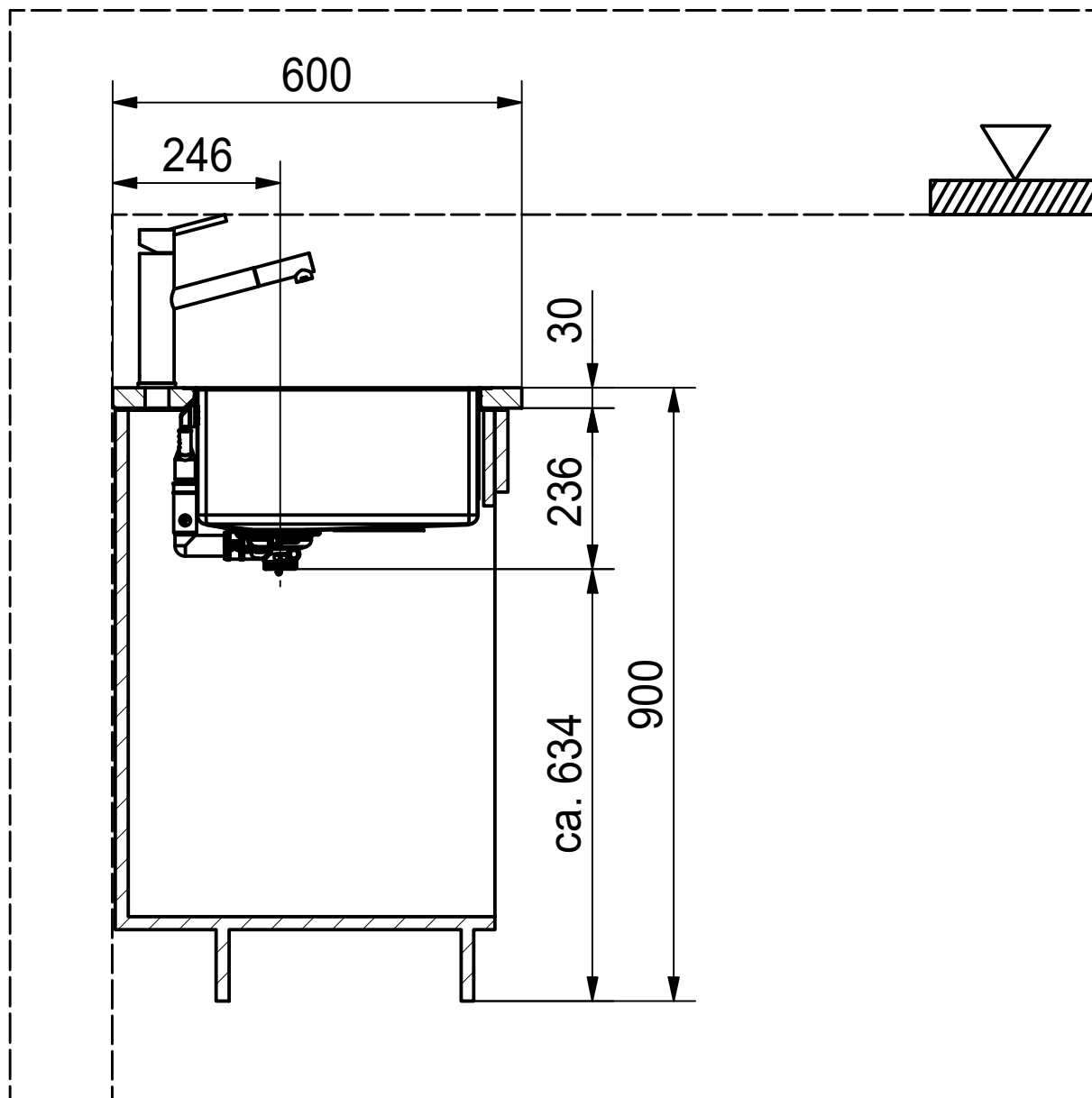

Drawing No.	20198784_02	Revision	
Drawn Date	16.11.2020		
<small>These drawings and specifications are the property of Franke Technology and Trademark Ltd. and shall not be reproduced, copied or transferred to any third party without the prior written permission of Franke Technology and Trademark Ltd., Hergiswil, Switzerland</small>			



BXM 210/110-50 SI
Installing document

Sheet	Sheets
2	11

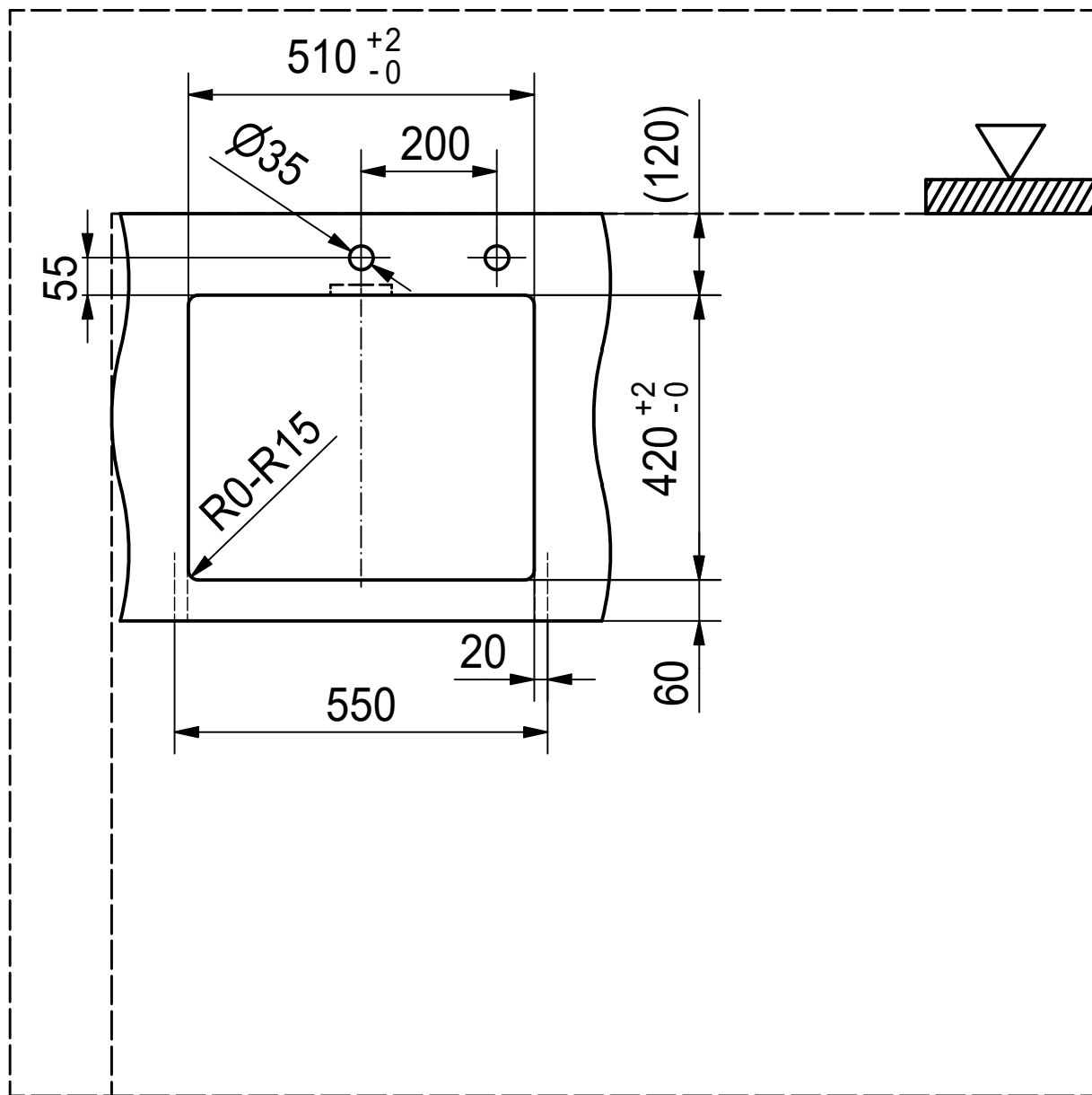

for flush fit only

15 x 90
45°
for overflow area
flush & top mount only

Drawing No.	20198784_02	Revision	
Drawn Date	16.11.2020		
These drawings and specifications are the property of Franke Technology and Trademark Ltd. and shall not be reproduced, copied or transferred to any third party without the prior written permission of Franke Technology and Trademark Ltd., Hergiswil, Switzerland			



BXM 210/110-50 SI
Installing document

Sheet	Sheets
3	11

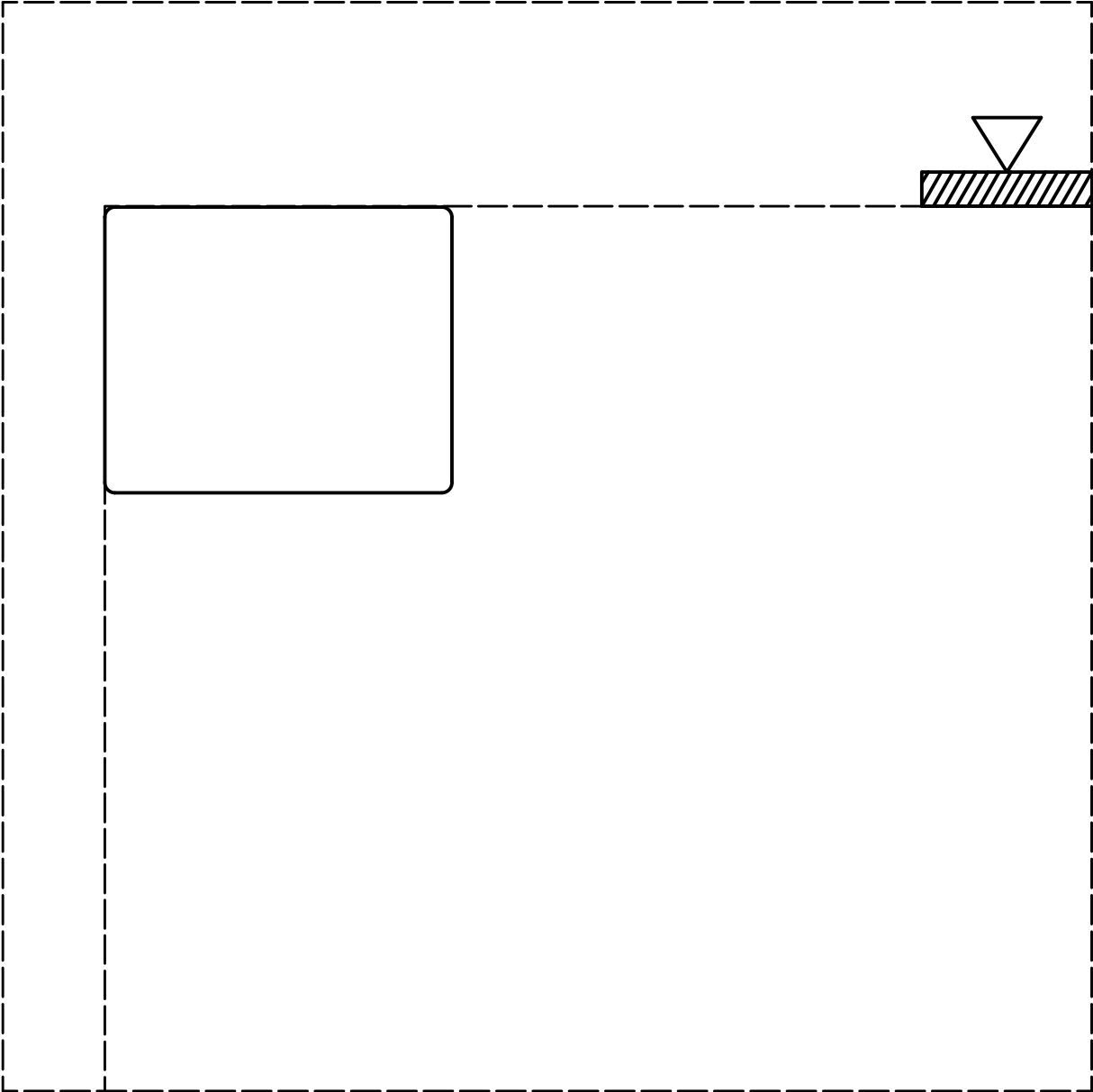

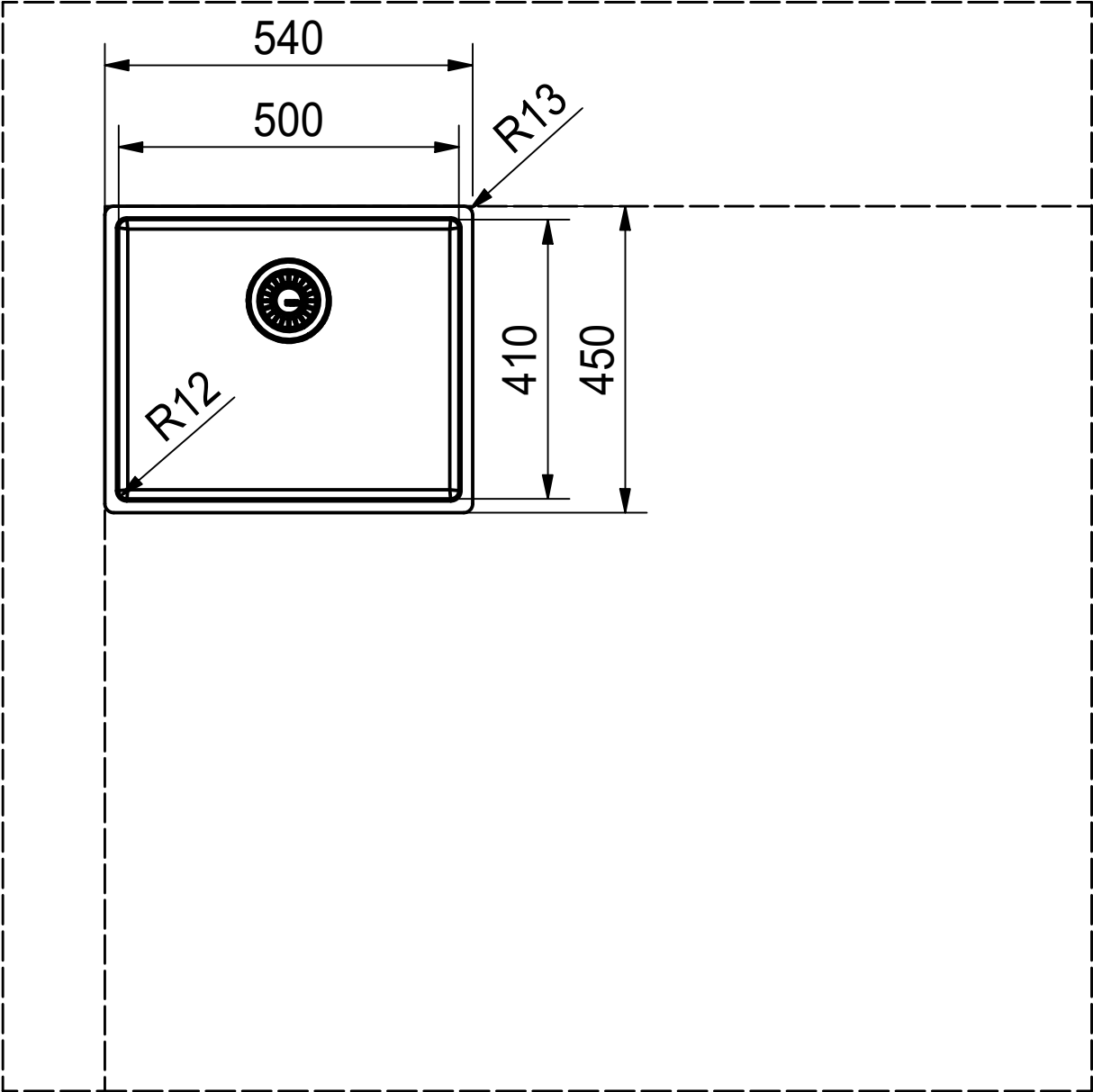

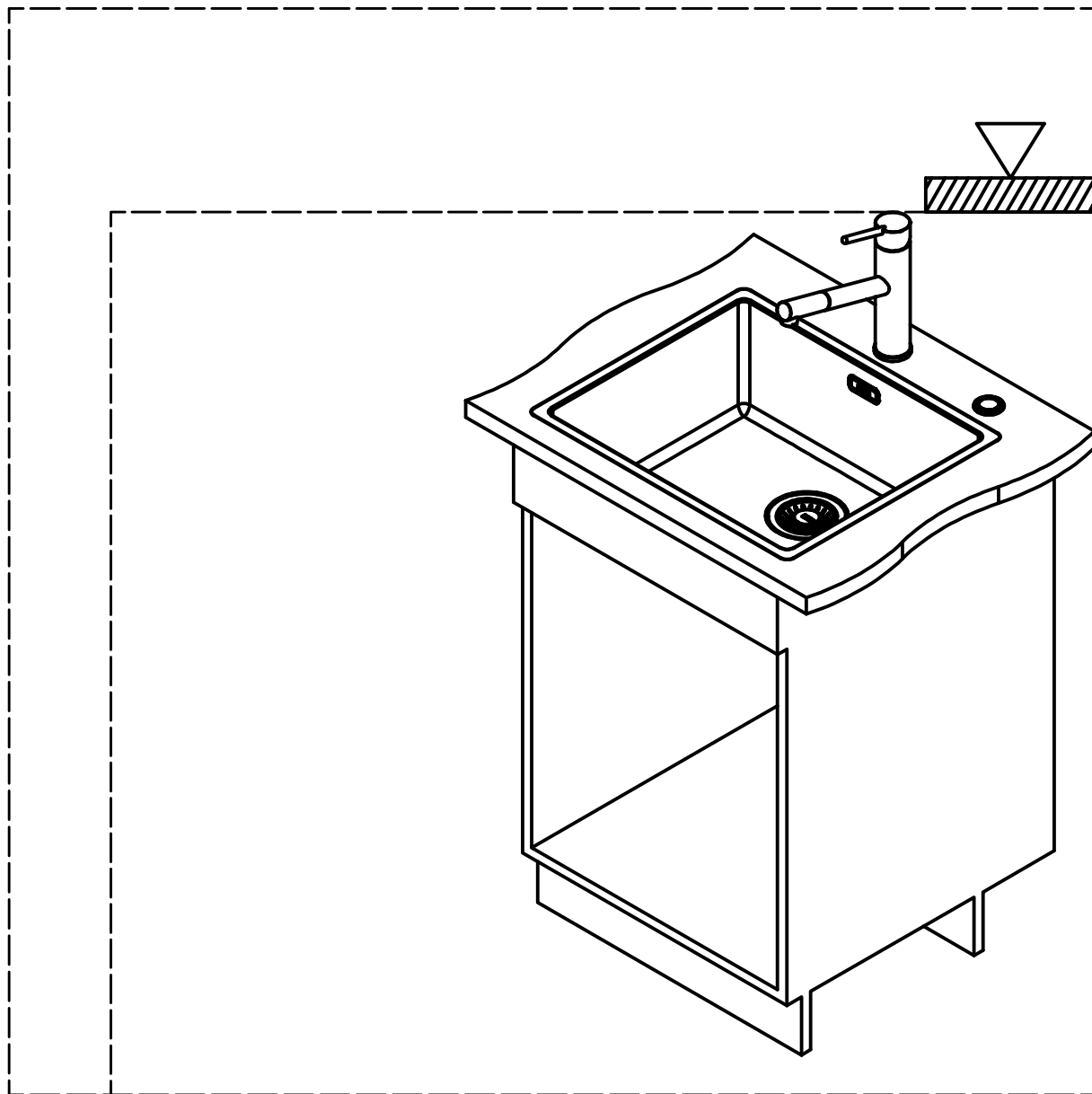

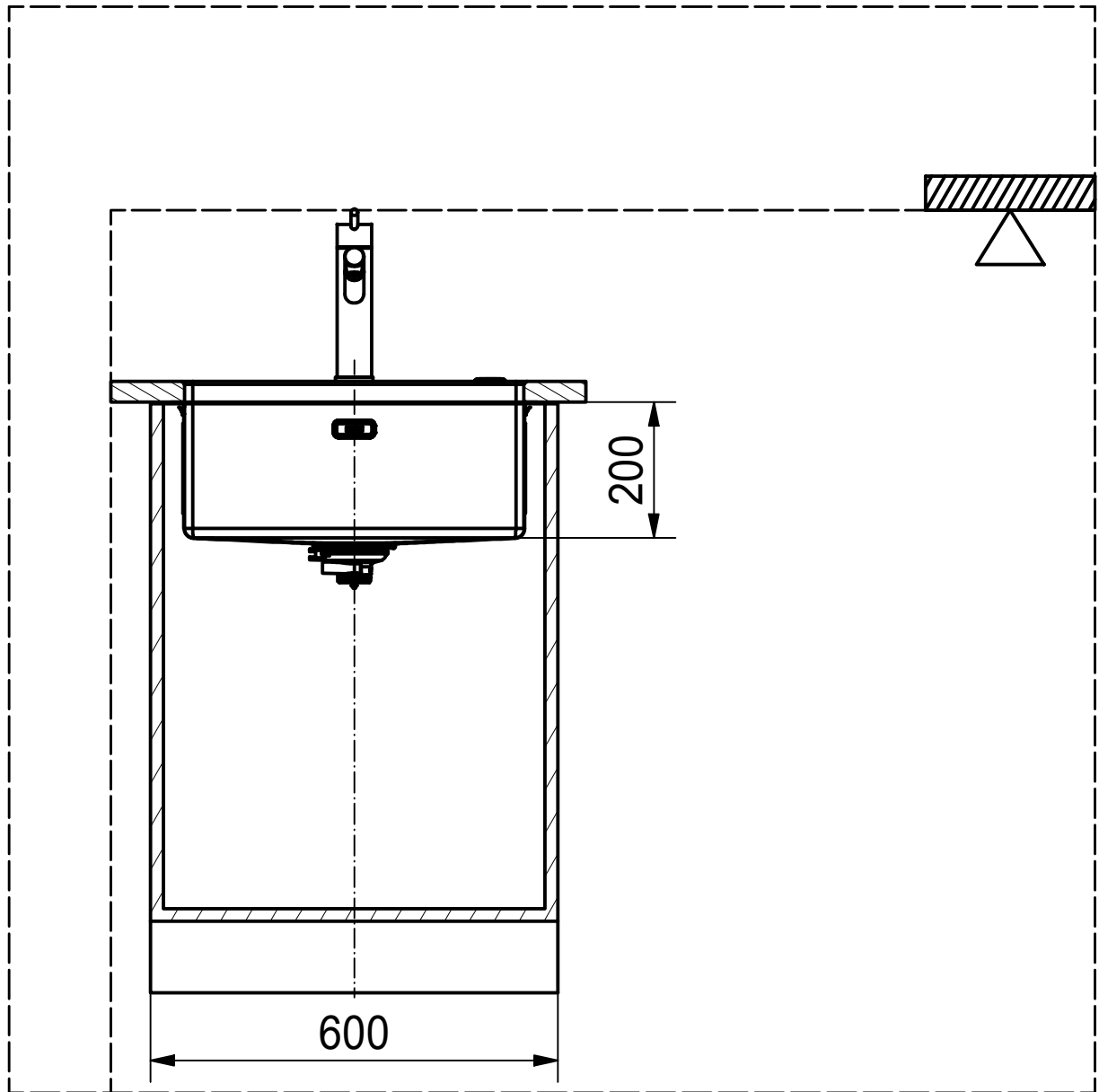

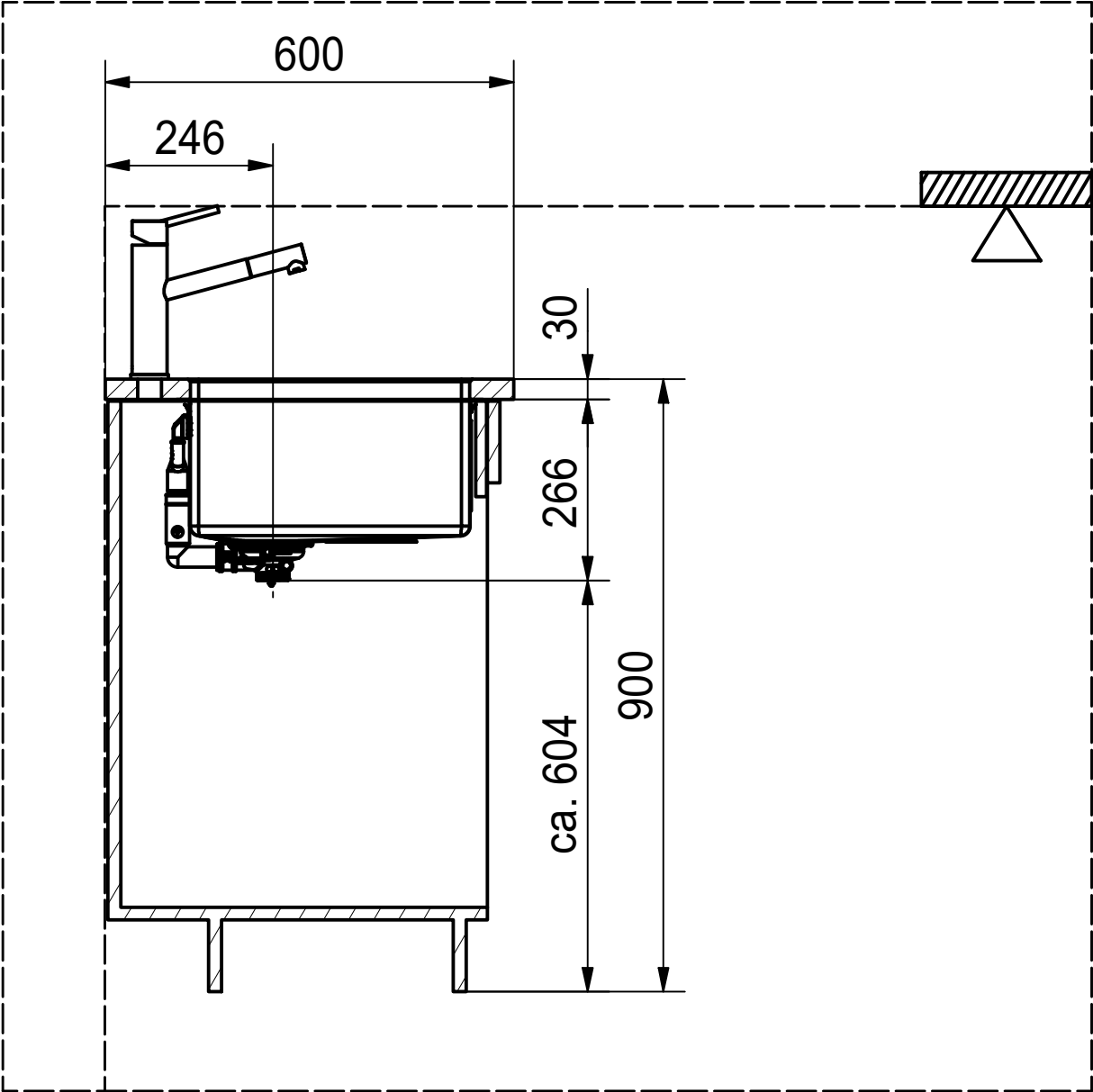

CO

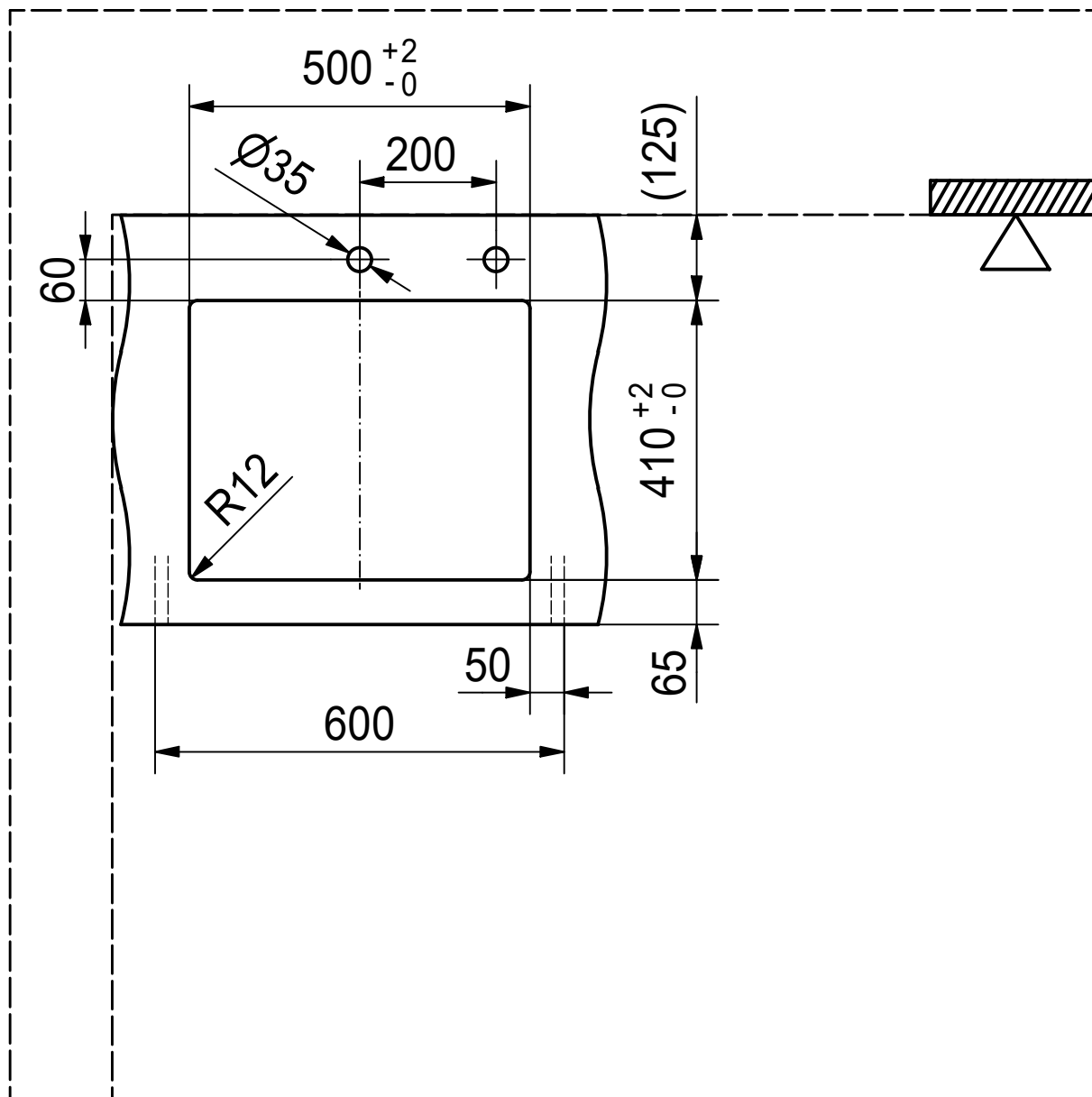

Drawing No.	20198784_02	Revision			BXM 210/110-50 SI Installing document	Sheet	Sheets
Drawn Date	16.11.2020					9	11
These drawings and specifications are the property of Franke Technology and Trademark Ltd. and shall not be reproduced, copied or transferred to any third party without the prior written permission of Franke Technology and Trademark Ltd., Hergiswil, Switzerland							

