

## MAINTENANCE

1. With normal use, maintenance should not be necessary. Should there be an extended period where the dispenser isn't used, it is possible the soap/lotion could harden and clog the dispenser. In this event, submerge the entire dispensing head with pump into hot water for several minutes. Next pump hot water through the assembly. Repeat as necessary to remove the clog.

2. To clean the dispenser, use a soft cloth or sponge with soap and water only. Do not use any abrasive cleaners or pads. Dry with a cloth or paper towel.

### 3. Replacement Parts

- 1 - Pump SD 3101
- 2 - Bottle SD 3102
- 3 - Fill Tube SD 3103

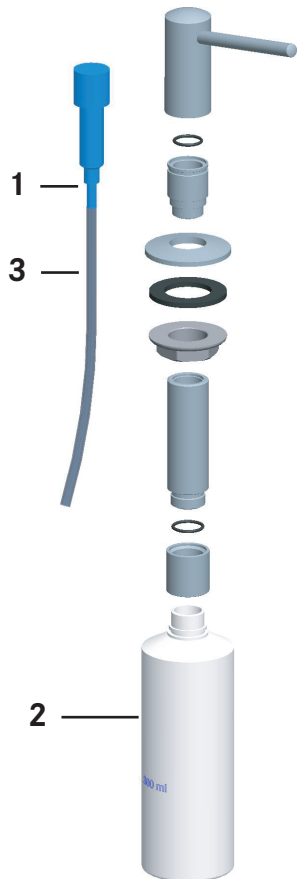

## PRODUCT WARRANTY

Congratulations on the purchase of this Franke product! Franke is one of the world's largest manufacturers of kitchen systems. Our products are manufactured using the highest degree of technology, quality, and design. As a result, we are proud to offer the following warranty. Franke warrants the quality of its soap/lotion dispensers to be free from manufacturing defects for a period of five years from the date of purchase.

This warranty applies only to the original owner, providing the product has been installed in accordance with these installation instructions, used as recommended, and in normal residential application. In the event of a warranty claim, the owner will be required to provide proof of purchase - **SAVE ORIGINAL SALES RECEIPT!**

This warranty covers all components which make the product operational. Franke reserves the right to inspect the installation prior to the replacement of the product or component part.

This warranty does not cover misuse or abuse, accidental damage, scuffs, or scratches, abnormal usage, negligence or damage caused by improper maintenance or cleaning. Normal wear of parts is excluded from the warranty. Damage caused by impurities or acts beyond Franke's control are not covered. Any product or part which has been repaired or altered in any manner outside of Franke's factory, unless previously authorized in writing by Franke, will void the warranty.

Any replacement excludes transportation and any labor reinstallation costs. This warranty doesn't allow recovery of incidental or consequential damages such as loss of use, delay, property damage, or other consequential damage, and Franke accepts no liability for such damages. The Franke warranty is limited to the above conditions and to the warranty period specified herein and is exclusive. Franke **DISCLAIMS** all other warranties, expressed or implied, including the **IMPLIED WARRANTIES OF MERCHANTABILITY AND/OR FITNESS FOR A PARTICULAR PURPOSE**. This warranty gives you specific legal rights which may vary from state to state.

### Further Information

For any further information about Franke products, about the installation of them, or about the guarantee, please contact our Customer Service Department:

Franke Kitchen Systems, LLC  
800 Aviation Parkway  
Smyrna, TN 37167  
Phone: 1-800-626-5771  
Fax: 1-888-685-0007  
[www.franke.us/ks](http://www.franke.us/ks)

**In Canada:**  
Franke Kindred Canada Limited  
1000 Franke Kindred Road  
Midland, Ontario L4R4K9  
1-866-687-7465  
[info@kindred-sinkware.com](mailto:info@kindred-sinkware.com)

## INSTALLATION GUIDE

**Soap dispenser: SD3200, SD3201, SD3202, SD3203, SD3204, SD3205, SD3206, SD3207, SD3220, SD3222, SD3240, SD3261, SD3265, SD3270, SD3280, SD3290, KSD5500, KSD5501, KSD5502, KSD5503, KSD5505, KSD5507, KSD5550**

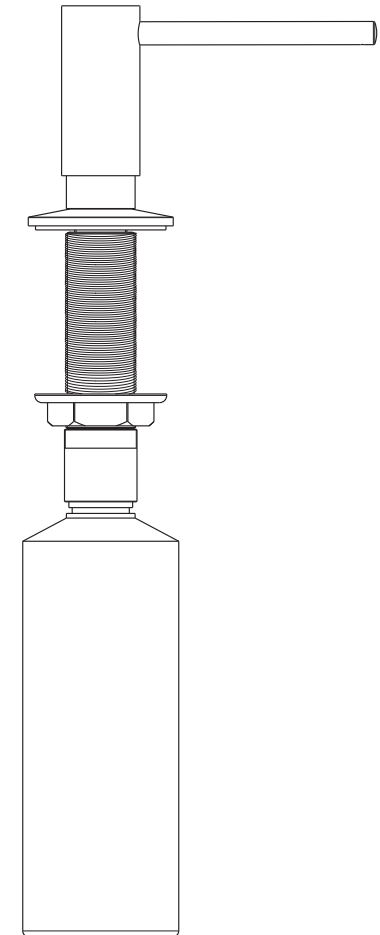

COD. 340V0020A7

## INSTALLATIONS INSTRUCTIONS

**NOTE:**  
Contact us immediatly if you see inconsistencies.

Phone: (1-800-626-5771)  
website: [www.franke.us/ks](http://www.franke.us/ks)  
email: [ks-customerservice.us@franke.com](mailto:ks-customerservice.us@franke.com)

### CONTENTS IN BOX

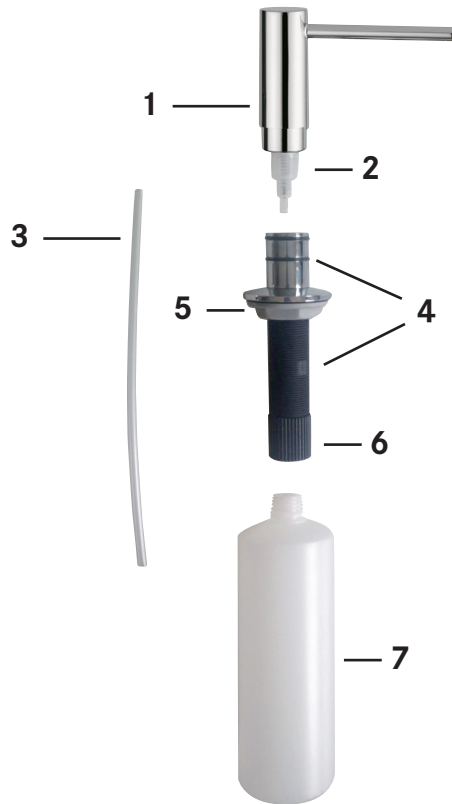
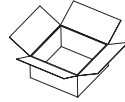

1 - Dispensing Head  
2 - Pump  
3 - Fill Tube  
4 - Base assembly  
(includes washer and shank)

5 - Mounting Nut  
6 - Connecting sleeve  
7 - Bottle

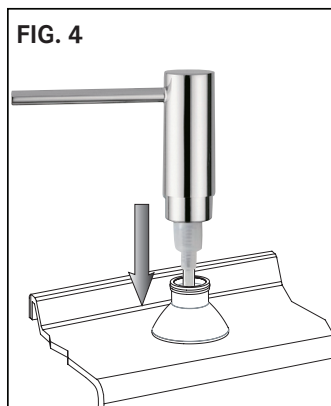
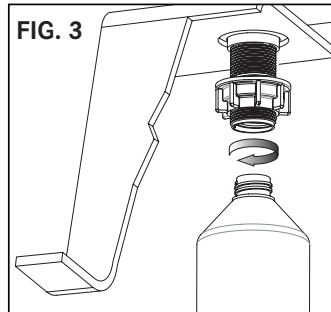
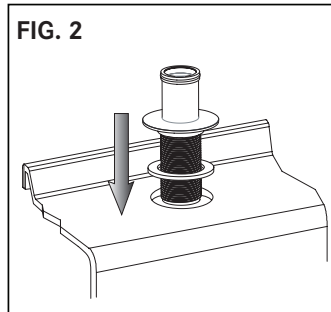
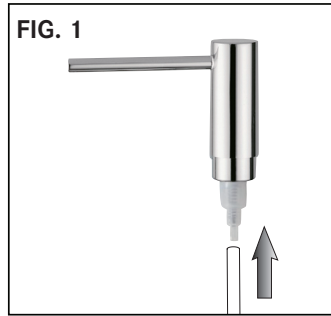

## INSTALLATIONS INSTRUCTIONS

1. Remove all contents from package and check for completeness.
  2. Cut a 1-1/8" hole in the desired position in the mounting surface if one isn't available
  3. Connect fill tube (3) to pump (2) in dispensing head (1) as shown in Figure 1 and sit aside
  4. Unscrew connecting sleeve (6) from base assembly shank (4) and remove mounting nut (5)
  5. Insert base assembly (4) into the hole as shown Figure 2
  6. Screw mounting nut (5) and connecting sleeve (6) onto base assembly shank (4)
  7. Screw bottle into connecting sleeve (6) as show in Figure 3
  8. Fill bottle from top with soap or lotion
- Tip: to minimize clogging, fill bottle 1/3 with water and 2/3 soap and mix well using fill tube.
9. Insert dispensing head (1) with fill tube (2) into the base assembly (4) as shown in Figure 4
  10. Pump dispensing head several times until soap/lotion is discharged